



RESIDENCE
EIGHT

ABOUT THE DEVELOPER

SKY AD. is owned by a regional market leader that has gained a strong foothold in Abu Dhabi and Al-Ein by setting the benchmark in integrated excellence; offering a multitude of residential and commercial components spanning schools, business parks, and best-in class utilities.

Boasting a vertically-integrated business model where the sky is the limit, SKY AD. Developments is a regional real estate developer, offering landmark mixed used developments that meld residential units with top-class leisure facilities to foster integration at every touchpoint.

SKY AD.'s vision is to satisfy the ever-evolving needs of the Egyptian real estate market by crafting sustainable and integrated communities of utmost quality and value, as well as successful partnerships with customers, steeped in an expanded investment portfolio.

**SKY AD.
DEVELOPMENTS**



INVEST IN TOMORROW TODAY

Why Cairo's New
Administrative Capital?

- A Strategic Location Like No other
- Only 60 km from Ain Sokhna, Suez and Central Cairo- granting you direct access to the high density population concentrated in Cairo, Delta and the Suez Canal
- Egypt's Brighter Future
- A sprawling 170,000 acres equivalent to Singapore in size and a modern, self-sufficient capital expected to attract a growing community of more than forty million people upon completion
- A Stable Investment Climate
- The capital's Downtown and its financial and business district alone roll out on 700,000 m2, attracting investments worth \$3.4 billion
- A Fully-Integrated Vision
- A fully-integrated capital, boasting world-class residential, commercial, medical and financial establishments, in addition to some of the world's leading educational institutions, as well as diverse arts and culture hubs
- Unrivalled Accessibility
- An independent International Airport, in addition to an electric train connecting the 10th of Ramadan with Belbeis- and a main train station connected to Egypt's railway system
- Unmatched Safety
- More than six thousand surveillance cameras, in addition to innovative public safety services, ensuring a worry-free, protected environment



THE FUTURE HAS FOUND IT'S PERMANENT HOME

Step into a naturally-inspired world backdropped by intricate beauty & anchored in family laughter wherever you turn. Every moment of life here is mindfully maximized to dictate cherished experiences & multi-sensory luxuries, shared with a hand-picked community of ultimate privacy. Open your eyes on the finer things in life & invest in the only destination where infinite green views equally multiply. Indulge in an atmospheric lifestyle where generations effortlessly unite bringing lasting memories & an elevated sense of enjoyment to your everyday life.

Residence Eight

Futuristic home where soulful possibilities & natural beauty abounds.

Experience The Best of Tomorrow Today

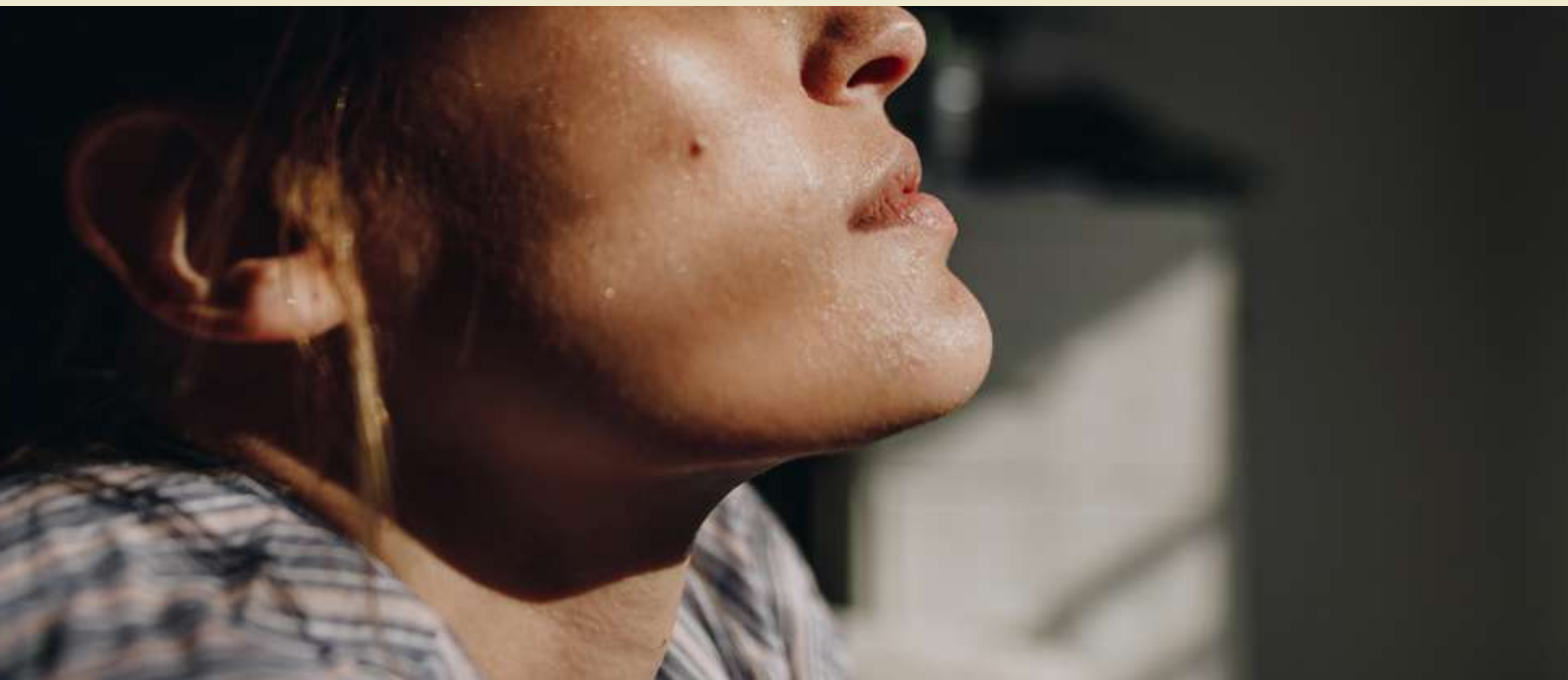

Disclaimer

1.All dimensions will be measured from axis to axis. 2.All materials,dimensions and drawings are approximate information is subject to change without notice. 3.Actual area may vary from the stated area. 4.Drawing areas not to scale. 5.The developer reserves the right to make revisions. 6.Actual unit areas, front windows, porches, terraces,loggia and exterior trim detail may vary by elevation styles.





GREEN VIEWS X 2

Introducing

RESIDENCE
EIGHT



Green Views Multiplied By Two

Crowning a prime location in R8's Diplomatic District, Residence Eight is mindfully masterplanned on 23 acres of land, dedicating 82% to greenery to introduce a unique flair of smart luxury and seamless walkability, steeped in inspiring 360 degree views - equally captured from inside and outside your home-. The iconic development is the first of its kind in Cairo's New Administrative Capital to harmonize the human experience with its natural surroundings by directly opening onto 70 acres, thanks to its exclusive location facing the district's sports club, as well as the Green River, surrounding it from every touch-point.





A Never-Ending Journey of Enriching Discovery

Built around residents' varied needs, Residence Eight is an experience-oriented destination planned with a reverence for the finer things in life. All homes are thoughtfully designed to embrace unobstructed views on magical landscapes while evoking unique sentiments of calm by combining three shades of verdant green, tranquil blue and pearl hardscape.

The urban mixed use development opens your eyes on an aesthetic canvas of contemporary elegance, perfected by breathing parks, flowing water features, shimmering pools and lagoons, as well as animated pedestrian walks for ultimate recreation year-round.

Residence Eight is a self-sufficient world of its own, boasting an atmospheric 20 meter commercial anchor, a 40 meter promenade extending across its lively masterplan and an elegantly-appointed club house for unwinding and socializing all day long.





RESIDENCE EIGHT

An ever-evolving journey of non-stop discovery, melding continuous landscapes with smart technology and intuitive routes to foster car-free movement and timeless inspiration, guaranteeing to wow you wherever you turn.

DESIGNED IN HARMONY WITH NATURE'S GIFT

Residence Eight's Unique Orientation

Expertly designed by internationally-acclaimed YBA in collaboration with SKY AD., Residence Eight introduces a pioneering vision that reengages the forces of sun and wind to foster an ecology-based future. By carefully analyzing the direction of winds, the sun's movement and greenery surrounding the site, Residence Eight embodies ideal principles of harmony with nature to promote human health, as well as year-round wellbeing through equal views for all homeowners alike.

The landmark development blends perfectly into breathing landscapes, embellished by a green sight all around to maximize natural light and ventilation, shaded areas in harsh sun hours, as well as magical views from both inside and outside your house. All homes are planned on equally spaced V-shaped clusters facing North to allow cool breeze inside each unit while creating expansive spaces where people can entirely enjoy nature in a more intimate way.



A WORLD OF CONVENIENCE TO CALL HOME

Masterplanned with the community's convenience in mind, Residence Eight enjoys a strategic location on the West entrance of R8 Diplomatic District, facing the only sports club in the area from the North while opening onto Mohamed Bin Zayed's Northern Axis for ultimate accessibility to all vital points in Cairo. The development's land aesthetically stretches along the Green River from its south to surround you with non-stop recreation while being just minutes away from Cairo's New Administrative Capital's leading educational hub, as well as its thriving Arts and Culture District.

- 20** Minutes from New Cairo
- 25** Minutes from Suez Road
- 35** Minutes from Airport
- 40** Minutes from Heliopolis
- 60** Minutes from Downtown

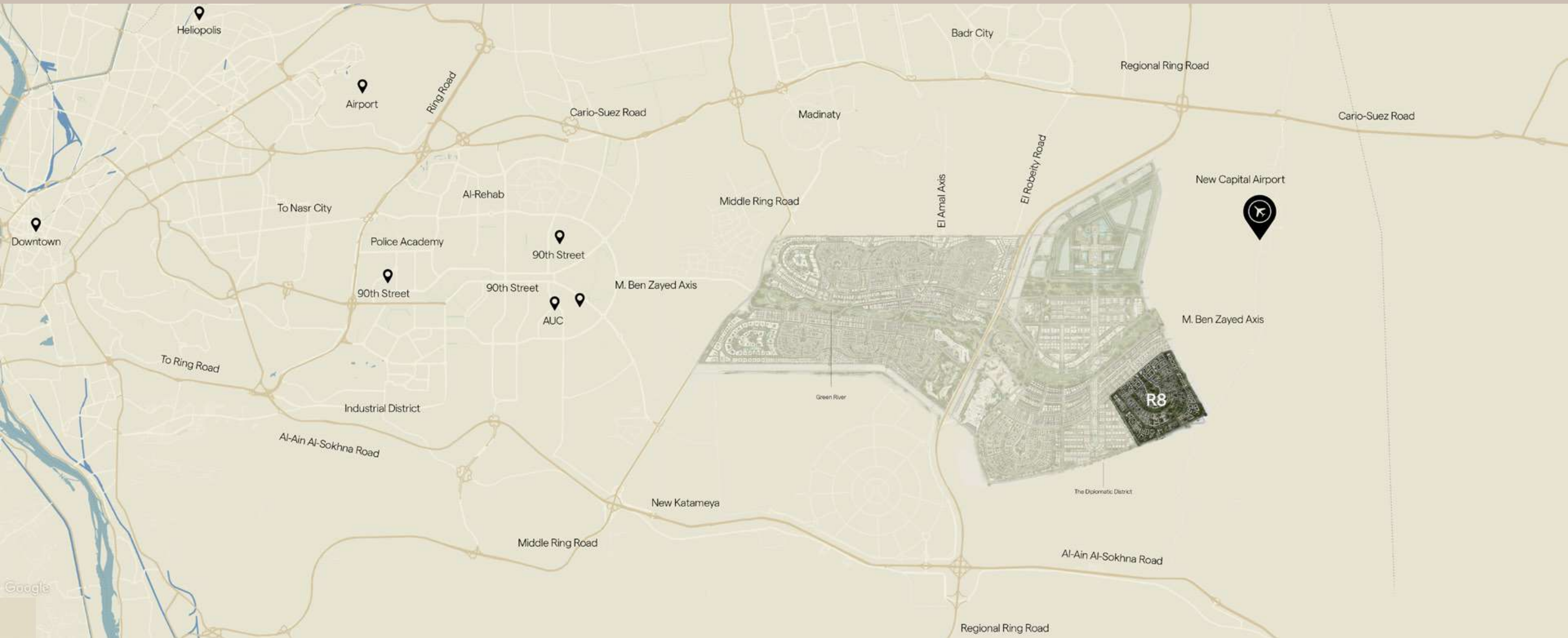

NEW CAPITAL MASTER PLAN



NEW CAPITAL AMENITIES

-  0.8 KM Diplomatic District
-  5.5 KM Investment Zone
-  2.5 KM New Capital Cathedral
-  3.2 KM New Capital Mosque
-  10 KM Airport
-  4.1 KM Government Center
-  1.6 KM Opera
-  5.3 KM Medical City
-  4.8 KM Conference Center

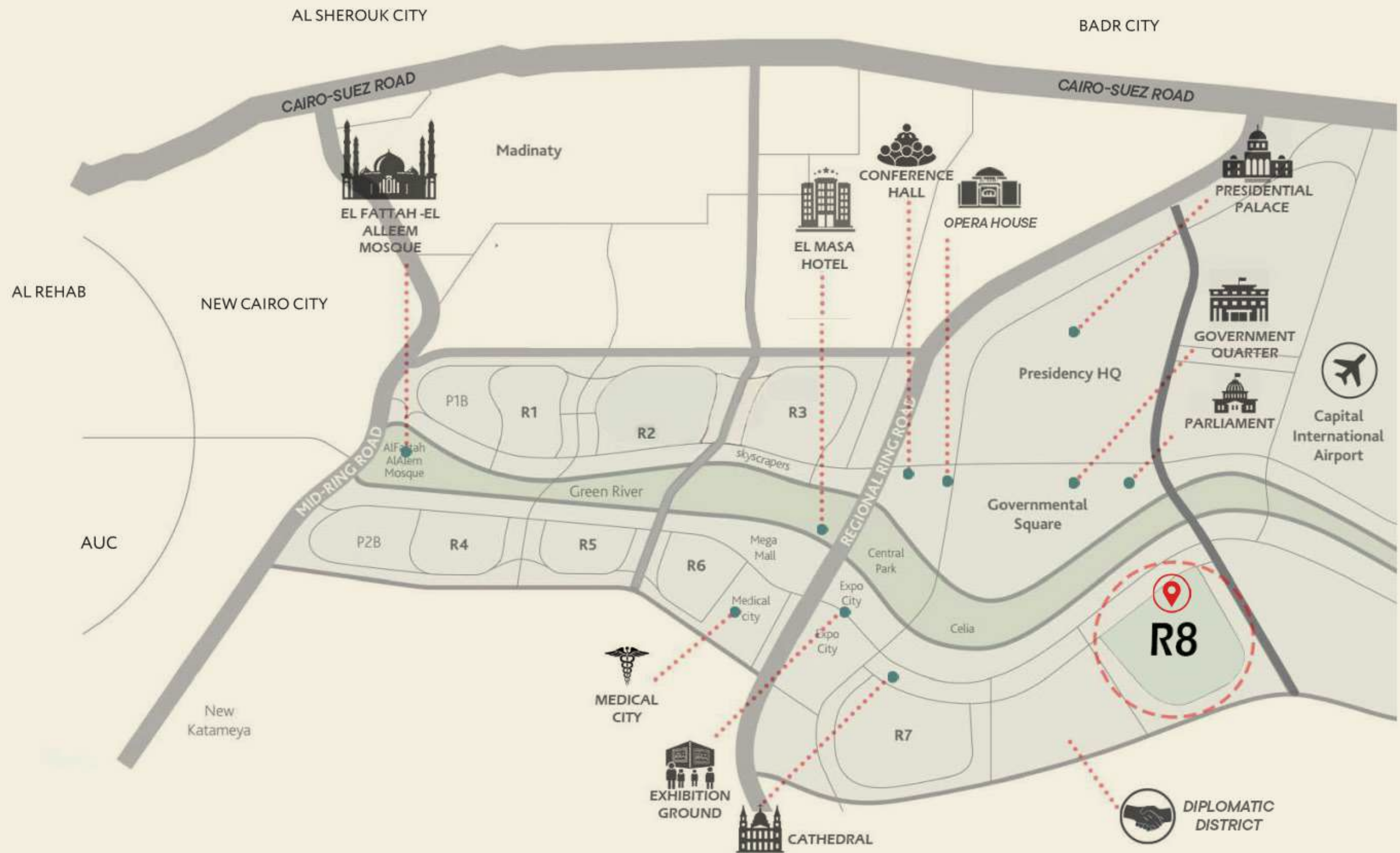



HOME IS
EVERYTHING YOU
CAN WALK TO

AN INTEGRATED VISION OF FUTURISTIC FLOW

Residence Eight is carefully planned to deliver life's most treasured experiences at your door. By putting seamlessly accessibility and enjoyable walkability as the cornerstones of its masterplan, the development reflects a flowing sense of dynamic movement, as well as friendly discovery through manicured landscapes and tranquil water features, extending throughout its V-Shaped clusters. Ideal for the whole family, each cluster allows residents' to decelerate or connect in animated communal

spots between buildings which seamlessly transform from quiet reading corners, play areas and meditation spots in the morning to lively happening hang-outs at night. By utilizing an open network of integrated spaces, comprised of courtyards and connected open routes, families can easily enjoy free mobility via a lively promenade —rolling out across the project- perfected by a unique melange of retail, dining and shopping experiences that never fail to impress in every step.

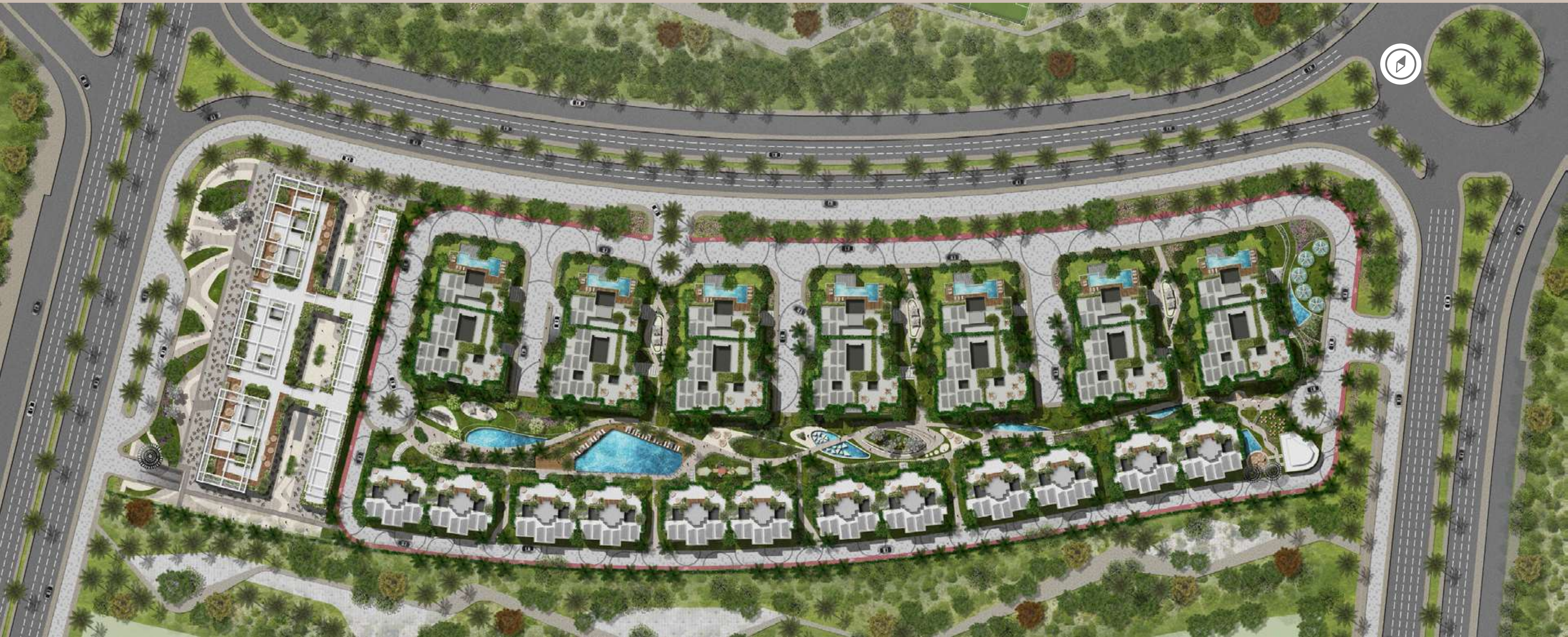



AN AESTHETIC UNION OF FUNCTION AND FORM INSPIRED DESIGN

From certain vantage points buildings at Residence Eight are seen as a landmark and from others, they are seen as a part of low scale urban fabric. They look different- because they simply perform differently.

Inspired by Dubai's dynamic and staggered outlook on typology, Residence Eight introduces two connected buildings per cluster, using an innovative perimeter block housing form, allowing for layered experiences to unfold. The façade reflects deep cascading blocks that become private terraces to frame equal views for all homeowners alike while providing sun shading and optimizing day- light and natural ventilation all year long.

Residence Eight's buildings are seamlessly adjoined on V-shaped plots to lend each unit expansive views without interruption while flexibly accommodating four spacious units per floor with sizes ranging from 80 to 350 sqm. Each building enjoys a private entrance, powered by smart access control, personal lifts, as well as a spacious underground parking - with a separate designated area for visitors-. The rooftops take luxury living to new heights by opening onto a world of endless recreation through an abundance of top-class amenities for homeowners' delight.

From roof deck Jacuzzis, cozy barbecue spots to cutting-edge gyms, Residence Eight's inspired design aims at enriching the life of its community at every touchpoint.

Disclaimer

1.All dimensions will be measured from axis to axis. 2.All materials,dimensions and drawings are approximate information is subject to change without notice. 3.Actual area may vary from the stated area. 4.Drawing area is not to scale. 5.The developer reserves the right to make revisions. 6.Actual unit areas, front windows, porches, terraces,loggia and external trim detail may vary by elevation styles.



A close-up photograph of a woman's face, focusing on her eyes and nose. The lighting is dramatic, with one side of her face in shadow and the other highlighted by a warm, golden light. Her expression is contemplative.

LIVE WHERE EVERY MOMENT COUNTS

8760 Hours — 365 Days of Wondrous Discovery



RESIDENCE EIGHT'S COMMERCIAL DISTRICT WHERE MEMORABLE MOMENTS COME ALIVE

Residence Eight's 20 meter Commercial District is a lively social nexus, dedicating 15,000 sqm to administrative and entertainment excellence, embracing green views, as well as an abundance of colorful experiences to delight the entire family. Serving as an anchor point for its residential community, as well as visitors enjoying a brisk stroll on the Green River, the commercial district spoils you for choice by offering a multitude of world-class shopping experiences, culinary adventures and non-stop entertainment, perfected by impeccable service and lively performances, year-long.

Artisanal Bistros

Atmospheric Coffee Shops

Authentic Restaurants

lively performances

Impeccable Service

Upscale Shopping Experiences

Treasured Moments for the whole Family





RESIDENCE EIGHT'S LIVELY PROMENADE BREATHING RECREATION TO INSPIRE

Residence Eight's 400 meter promenade is an exclusive invitation to journey into beauty where every manicured detail is planned to inspire and delight. Expertly planned to foster walkable experiences through pedestrian-friendly paths and animated routes, life here is simply exciting discovery on repeat. Enjoy a morning stroll in sun-drenched landscapes, perfected by the chirping of birds and the soothing sounds of flowing lagoons. Decelerate in the shade with loved ones and enjoy a refreshing yoga routine in green pocket parks. Take a dip in shimmering pools, as your kids safely play before your eyes. When the day draws to an end, connect with a forward-thinking community over an open air barbecue and admire the finer things in life.



SEAMLESS WALKABILITY

MINDFUL MOMENTS

REFRESHING RECREATION

MEMORABLE INTERACTION





RESIDENCE EIGHT'S EXCLUSIVE CLUB HOUSE A SANCTUARY OF CONTEMPORARY CALM

Residence Eight's Club House captures the best in signature luxury, perfected by intimate contemporary settings with views for life. Boasting its own swimming pool and a multitude of dining alternatives, the club house is an ideal place to retreat from stresses of city life while indulging in memorable social encounters where nature multiplies. Whether it's sipping on a refreshing cocktail as you soak up the sun, enjoying a good read perfected by delicious bites or simply connecting with friends in a larger than life ambience, Residence Eight's Club House is your daily dose of inspiration and sanctuary of calm.

INTERIOR SHOTS

Disclaimer

1.All dimensions will be measured from axis to axis. 2.All materials,dimensions and drawings are approximate information is subject to change without notice. 3.Actual area may vary from the stated area. 4.Drawing areas not to scale. 5.The developer reserves the right to make revisions. 6.Actual unit areas, front windows, porches, terraces,loggia and exterior trim detail may vary by elevation styles.



Disclaimer

1.All dimensions will be measured from axis to axis. 2.All materials,dimensions and drawings are approximate information is subject to change without notice. 3.Actual area may vary from the stated area. 4.Drawing areas not to scale. 5.The developer reserves the right to make revisions. 6.Actual unit areas, front windows, porches, terraces,loggia and exterior trim detail may vary by elevation styles.



Disclaimer

1.All dimensions will be measured from axis to axis. 2.All materials,dimensions and drawings are approximate information is subject to change without notice. 3.Actual area may vary from the stated area. 4.Drawing areas not to scale. 5.The developer reserves the right to make revisions. 6.Actual unit areas, front windows, porches, terraces,loggia and exterior trim detail may vary by elevation styles.





Disclaimer

1.All dimensions will be measured from axis to axis. 2.All materials,dimensions and drawings are approximate information is subject to change without notice. 3.Actual area may vary from the stated area. 4.Drawing areas not to scale. 5.The developer reserves the right to make revisions. 6.Actual unit areas, front windows, porches, terraces,loggia and exterior trim detail may vary by elevation styles.

FLOOR PLANS

BUILDING S

RESIDENCE
EIGHT

Ground Floor

Disclaimer

1.All dimensions will be measured from axis to axis. 2.All materials,dimensions and drawings are approximate information is subject to change without notice. 3.Actual area may vary from the stated area. 4.Drawing areas not to scale. 5.The developer reserves the right to make revisions. 6.Actual unit areas, front windows, porches, terraces,loggia and exterior trim detail may vary by elevation styles.



S - GARDEN APARTMENT A-G1/G2

Available on Ground Floor. Private Garden **95 m²** Terrace 01 **1.20 × 1.75 m²** Total Area **215 m²**

Entrance
2.87 × 2.04 m²

Bedroom 03
3.72 × 3.91 m²

Reception
3.99 × 7.55 m²

Guest Toilet
1.48 × 2.31 m²

Dinning
2.44 × 3.64 m²

Bathroom
1.82 × 2.81 m²

Kitchen
3.56 × 3.56 m²

M. Bathroom
1.82 × 2.70 m²

Master Bedroom
3.79 × 4.09 m²

Maid Room
2.13 × 1.67 m²

Dressing
2.50 × 2.65 m²

Maid Toilet
2.13 × 1.03 m²

Bedroom 01
3.72 × 4.11 m²

Lobby 01
1.28 × 5.99 m²

Bedroom 02
3.91 × 4.11 m²

Lobby 02
1.30 × 1.82 m²

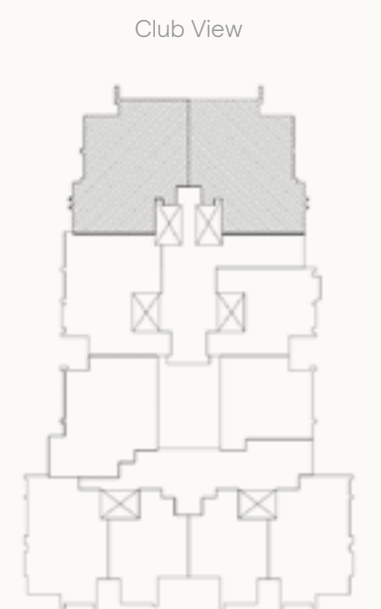

Disclaimer:

1.All dimensions will be measured from axis to axis. 2.All materials,dimensions and drawings are approximate information is subject to change without notice. 3.Actual area may vary from the stated area. 4.Drawing areas not to scale. 5.The developer reserves the right to make revisions. 6.Actual unit areas, front windows, porches, terraces,loggia and exterior trim detail may vary by elevation styles.

S - GARDEN APARTMENT A-G3

Available on Ground Floor. Private Garden **70 m²** Terrace 01 **1.05 × 2.10 m²** Total Area **175 m²**

Entrance
1.52 × 2.26 m²

Bedroom 01
3.91 × 3.91 m²

Reception
8.66 × 4.07 m²

Bedroom 02
3.91 × 3.72 m²

Living
3.78 × 3.73 m²

Guest Toilet
1.58 × 1.97 m²

Kitchen
3.19 × 3.34 m²

Bathroom
1.92 × 2.50 m²

Master Bedroom
3.91 × 4.08 m²

M. Bathroom
2.00 × 2.74 m²

Dressing
2.11 × 2.74 m²

Lobby 01
1.28 × 1.36 m²

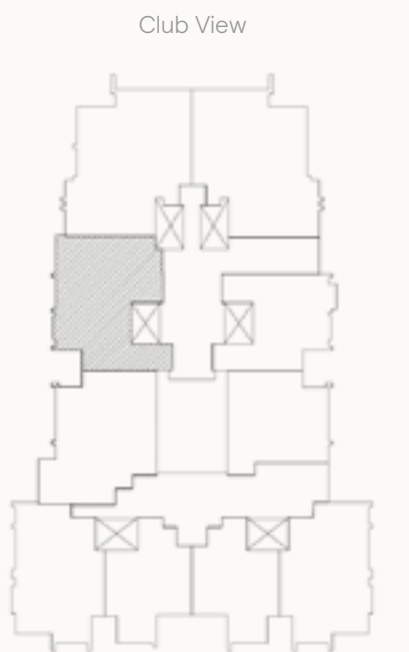

Disclaimer:

1.All dimensions will be measured from axis to axis. 2.All materials,dimensions and drawings are approximate information is subject to change without notice. 3.Actual area may vary from the stated area. 4.Drawing areas not to scale. 5.The developer reserves the right to make revisions. 6.Actual unit areas, front windows, porches, terraces,loggia and exterior trim detail may vary by elevation styles.

S - GARDEN DUPLEX A-G4

Available on Ground Floor. Private Garden **40 m²** Terrace 01 **1.05 × 2.10 m²** Total Area **245 m²**

Stairs
2.83 × 3.25 m²

Laundry
1.12 × 2.75 m²

Reception
4.19 × 7.57 m²

Maid Room
1.49 × 3.00 m²

Dining
3.51 × 3.91 m²

Maid Toilet
1.88 × 1.18 m²

Kitchen
3.78 × 4.29 m²

Lobby 01
1.32 × 1.32 m²

Guest Toilet
2.46 × 1.32 m²

Terrace 02
0.30 × 2.44 m²

Terrace 03
0.30 × 2.44 m²

Living
3.79 × 3.78 m²

Bedroom 02
3.91 × 3.79 m²

Master Bedroom
3.91 × 4.16 m²

Bathroom
1.85 × 2.50 m²

Dressing
2.12 × 2.75 m²

M. Bathroom
2.75 × 2.00 m²

Bedroom 01
3.91 × 3.91 m²

Lobby
1.85 × 1.28 m²



Disclaimer:

1.All dimensions will be measured from axis to axis. 2.All materials,dimensions and drawings are approximate information is subject to change without notice. 3.Actual area may vary from the stated area. 4.Drawing areas not to scale. 5.The developer reserves the right to make revisions. 6.Actual unit areas, front windows, porches, terraces,loggia and exterior trim detail may vary by elevation styles.

Club View



Spine View

S - GARDEN DUPLEX B-G1

Available on Ground Floor. Private Garden **35 m²** Terrace 01 **1.24 × 1.66 m²** Total Area **255 m²**

Reception 7.63 × 4.31 m² Lobby 01 1.28 × 2.92 m²

Dining 3.66 × 3.39 m² Guest Toilet 1.46 × 2.59 m²

Stairs 2.74 × 3.43 m² Maid Room 2.74 × 2.40 m²

Store 2.74 × 1.00 m² Maid Toilet 2.74 × 1.19 m²

Terrace 01 **1.05 × 1.65 m²** Terrace 02 **0.30 × 2.44 m²**

Entrance 1.80 × 1.50 m² M. Bathroom 2.74 × 1.92 m²

Living 3.66 × 3.91 m² Master Bedroom 3.91 × 4.29 m²

Bathroom 2.74 × 1.89 m² Bedroom 01 3.91 × 3.91 m²

Lobby 01 3.72 × 1.28 m² Bedroom 02 3.91 × 3.91 m²

Dressing 2.74 × 2.37 m²

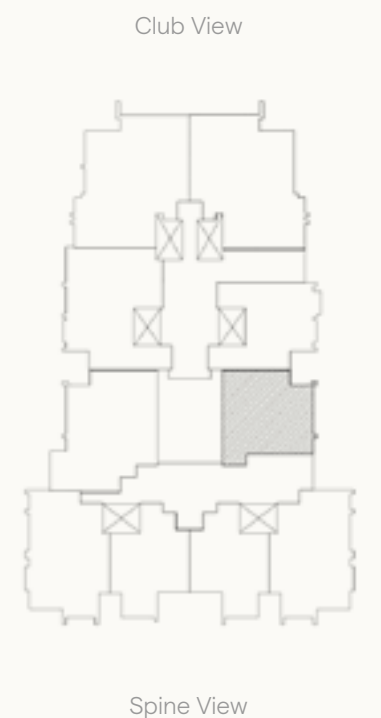

Disclaimer:

1.All dimensions will be measured from axis to axis. 2.All materials,dimensions and drawings are approximate information is subject to change without notice. 3.Actual area may vary from the stated area. 4.Drawing areas not to scale. 5.The developer reserves the right to make revisions. 6.Actual unit areas, front windows, porches, terraces,loggia and exterior trim detail may vary by elevation styles.

S - GARDEN APARTMENT B-G2

Available on Ground Floor. Private Garden **50 m²** Terrace 01 **1.05 × 1.66 m²** Total Area **175 m²**

Entrance
1.79 × 2.81 m²

Master Bedroom
3.91 × 4.29 m²

Reception
7.75 × 4.36 m²

M. Bathroom
2.74 × 1.91 m²

Kitchen
2.80 × 3.11 m²

Dressing
2.74 × 2.38 m²

Living
3.66 × 3.72 m²

Bathroom
2.74 × 1.89 m²

Bedroom 01
3.91 × 3.91 m²

Lobby 01
3.72 × 1.28 m²

Bedroom 02
3.91 × 3.72 m²

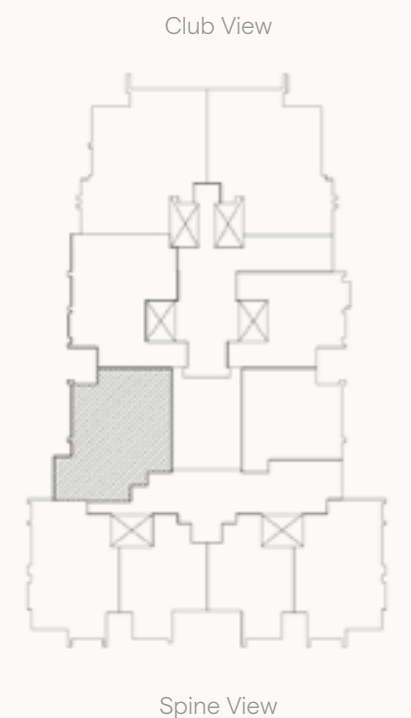

Disclaimer:

1.All dimensions will be measured from axis to axis. 2.All materials,dimensions and drawings are approximate information is subject to change without notice. 3.Actual area may vary from the stated area. 4.Drawing areas not to scale. 5.The developer reserves the right to make revisions. 6.Actual unit areas, front windows, porches, terraces,loggia and exterior trim detail may vary by elevation styles.

S - GARDEN APARTMENT B-G3/G6

Available on Ground Floor. Private Garden **98 m²** Terrace 01 **1.42 × 1.00 m²** Total Area **150 m²**

Entrance
1.81 × 2.74 m²

Reception
3.91 × 6.89 m²

Lobby 01
1.28 × 7.64 m²

Lobby 02
1.41 × 1.22 m²

Bathroom
2.52 × 1.82 m²

Kitchen
3.06 × 2.10 m²

Bedroom 01
3.79 × 3.91 m²

Bedroom 02
3.93 × 3.72 m²

Master Bedroom
4.30 × 4.11 m²

Dressing
1.80 × 2.42 m²

M. Bathroom
2.11 × 2.42 m²

Guest Toilet
2.72 × 1.35 m²

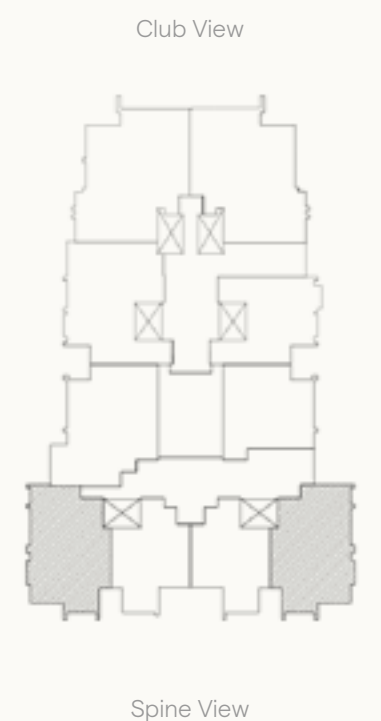

Disclaimer:

1.All dimensions will be measured from axis to axis. 2.All materials,dimensions and drawings are approximate information is subject to change without notice. 3.Actual area may vary from the stated area. 4.Drawing areas not to scale. 5.The developer reserves the right to make revisions. 6.Actual unit areas, front windows, porches, terraces,loggia and exterior trim detail may vary by elevation styles.

S - GARDEN APARTMENT B-G4/G5

Available on Ground Floor. Private Garden **39 m²** Terrace 01 **1.42 × 1.00 m²** Total Area **110 m²**

Entrance
1.81 × 2.74 m²

Lobby
1.32 × 2.72 m²

Kitchen
2.50 × 3.45 m²

Bathroom
2.62 × 1.82 m²

Reception
3.79 × 6.78 m²

Master Bedroom
3.89 × 3.91 m²

Bedroom 01
3.85 × 3.85 m²

M. Bathroom
2.59 × 1.88 m²



Disclaimer:

1.All dimensions will be measured from axis to axis. 2.All materials,dimensions and drawings are approximate information is subject to change without notice. 3.Actual area may vary from the stated area. 4.Drawing areas not to scale. 5.The developer reserves the right to make revisions. 6.Actual unit areas, front windows, porches, terraces,loggia and exterior trim detail may vary by elevation styles.

BUILDING S

RESIDENCE
EIGHT

First Floor

Disclaimer

1. All dimensions will be measured from axis to axis. 2. All materials, dimensions and drawings are approximate information is subject to change without notice. 3. Actual area may vary from the stated area. 4. Drawing areas not to scale. 5. The developer reserves the right to make revisions. 6. Actual unit areas, front windows, porches, terraces, loggia and exterior trim detail may vary by elevation styles.



S - DELUXE APARTMENT A-11/12

Available on
First Floor.

Total Area
220 m²

Terrace 01
1.10 × 8.30 m²

Terrace 02
1.20 × 1.75 m²

Entrance
2.87 × 2.04 m²

Reception
3.99 × 7.55 m²

Dinning
2.44 × 3.64 m²

Kitchen
3.56 × 3.56 m²

Master Bedroom
3.79 × 4.09 m²

Dressing
2.50 × 2.65 m²

Bedroom 01
3.72 × 4.11 m²

Bedroom 02
3.91 × 4.11 m²

Bedroom 03
3.72 × 3.91 m²

Guest Toilet
1.48 × 2.31 m²

Bathroom
1.82 × 2.81 m²

M. Bathroom
1.82 × 2.70 m²

Maid Room
2.13 × 1.67 m²

Maid Toilet
2.13 × 1.03 m²

Lobby 01
1.28 × 5.99 m²

Lobby 02
1.30 × 1.82 m²

Disclaimer:

1.All dimensions will be measured from axis to axis. 2.All materials,dimensions and drawings are approximate information is subject to change without notice. 3.Actual area may vary from the stated area. 4.Drawing areas not to scale. 5.The developer reserves the right to make revisions. 6.Actual unit areas, front windows, porches, terraces,loggia and exterior trim detail may vary by elevation styles.



S - PREMIUM APARTMENT A-13

Available on First Floor.	Total Area 190 m²	Terrace 01 2.15 × 6.60 m²	Terrace 02 0.30 × 2.44 m²
	Terrace 03 0.30 × 2.44 m²	Terrace 04 1.05 × 2.10 m²	

Entrance 1.52 × 2.26 m ²	Bedroom 01 3.91 × 3.91 m ²
Reception 8.66 × 4.07 m ²	Bedroom 02 3.91 × 3.72 m ²
Living 3.78 × 3.73 m ²	Guest Toilet 1.58 × 1.97 m ²
Kitchen 3.19 × 3.34 m ²	Bathroom 1.92 × 2.50 m ²
Master Bedroom 3.91 × 4.09 m ²	M. Bathroom 2.00 × 2.75 m ²
Dressing 2.11 × 2.75 m ²	Lobby 01 1.28 × 5.99 m ²



Disclaimer:

1.All dimensions will be measured from axis to axis. 2.All materials,dimensions and drawings are approximate information is subject to change without notice. 3.Actual area may vary from the stated area. 4.Drawing areas not to scale. 5.The developer reserves the right to make revisions. 6.Actual unit areas, front windows, porches, terraces,loggia and exterior trim detail may vary by elevation styles.

S - PREMIUM APARTMENT B-12

Available on First Floor.	Total Area 190 m²	Terrace 01 1.05 × 1.66 m²
	Terrace 02 0.30 × 2.44 m²	Terrace 03 3.32 × 5.93 m²

Entrance 1.79 × 2.81 m ²	Bedroom 02 3.91 × 3.72 m ²
Reception 7.75 × 4.36 m ²	Master Bedroom 3.91 × 4.29 m ²
Guest Toilet 2.74 × 1.32 m ²	M. Bathroom 2.74 × 1.90 m ²
Kitchen 2.80 × 3.11 m ²	Dressing 2.74 × 2.38 m ²
Living 3.66 × 3.72 m ²	Bathroom 2.74 × 1.89 m ²
Bedroom 01 3.91 × 3.91 m ²	Lobby 01 3.72 × 1.28 m ²

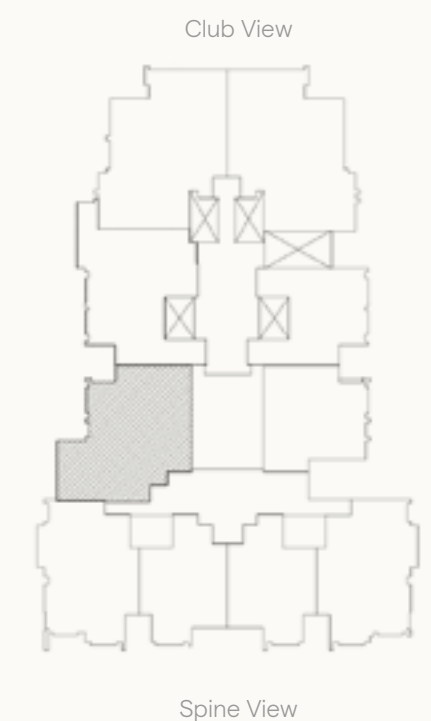

Disclaimer:
 1.All dimensions will be measured from axis to axis. 2.All materials,dimensions and drawings are approximate information is subject to change without notice. 3.Actual area may vary from the stated area. 4.Drawing areas not to scale. 5.The developer reserves the right to make revisions. 6.Actual unit areas, front windows, porches, terraces,loggia and exterior trim detail may vary by elevation styles.

S - CORNER APARTMENT B-13/16

Available on First Floor.	Total Area 160 m²	Terrace 01 1.10 × 4.20 m²	Terrace 02 0.30 × 1.64 m²
	Terrace 03 0.30 × 2.44 m²	Terrace 04 0.30 × 2.44 m²	Terrace 05 1.42 × 1.00 m²

Entrance
1.81 × 2.74 m²

Reception
3.91 × 6.89 m²

Lobby 01
1.28 × 7.64 m²

Lobby 02
1.41 × 1.22 m²

Bathroom
2.52 × 1.82 m²

Kitchen
3.06 × 2.10 m²

Bedroom 01
3.93 × 3.72 m²

Bedroom 02
3.79 × 3.91 m²

Master Bedroom
4.30 × 4.11 m²

Dressing
1.80 × 2.42 m²

M.Bathroom
2.11 × 2.42 m²

Guest Toilet
2.72 × 1.35 m²

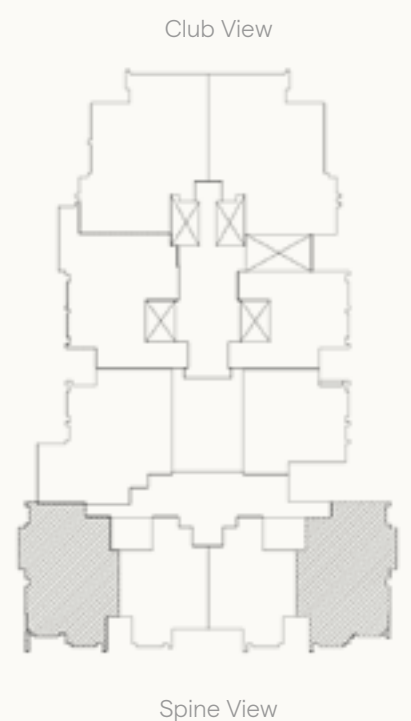

Disclaimer:

1.All dimensions will be measured from axis to axis. 2.All materials,dimensions and drawings are approximate information is subject to change without notice. 3.Actual area may vary from the stated area. 4.Drawing areas not to scale. 5.The developer reserves the right to make revisions. 6.Actual unit areas, front windows, porches, terraces,loggia and exterior trim detail may vary by elevation styles.

S - TYPICAL APARTMENT B-14/15

Available on First Floor.	Total Area 115 m²	Terrace 01 3.72 × 1.40 m²
	Terrace 02 1.42 × 1.00 m²	Terrace 03 2.74 × 0.30 m²

Entrance
1.49 × 2.22 m²

Lobby
1.32 × 2.72 m²

Kitchen
2.50 × 3.45 m²

Bathroom
2.62 × 1.82 m²

Reception
3.79 × 6.78 m²

Master Bedroom
3.89 × 3.91 m²

Bedroom 01
13.85 × 3.85 m²

M.Bathroom
2.59 × 1.88 m²



Disclaimer:

1.All dimensions will be measured from axis to axis. 2.All materials,dimensions and drawings are approximate information is subject to change without notice. 3.Actual area may vary from the stated area. 4.Drawing areas not to scale. 5.The developer reserves the right to make revisions. 6.Actual unit areas, front windows, porches, terraces,loggia and exterior trim detail may vary by elevation styles.

BUILDING S

RESIDENCE
EIGHT

Second Floor

Disclaimer

1.All dimensions will be measured from axis to axis. 2.All materials,dimensions and drawings are approximate information is subject to change without notice. 3.Actual area may vary from the stated area. 4.Drawing areas not to scale. 5.The developer reserves the right to make revisions. 6.Actual unit areas, front windows, porches, terraces,loggia and exterior trim detail may vary by elevation styles.



S - DELUXE APARTMENT A-21/22

Available on
Second Floor.

Total Area
220 m²

Terrace 01
1.10 × 7.90 m²

Terrace 02
1.20 × 1.75 m²

Entrance
2.87 × 2.04 m²

Reception
3.99 × 7.55 m²

Dinning
2.44 × 3.64 m²

Kitchen
3.56 × 3.56 m²

Master Bedroom
3.79 × 4.09 m²

M. Bathroom
1.82 × 2.70 m²

Dressing
2.50 × 2.65 m²

Bedroom 02
3.91 × 3.72 m²

Bedroom 03
3.72 × 3.91 m²

Guest Toilet
1.48 × 2.31 m²

Bathroom
1.82 × 2.81 m²

Maid Room
2.13 × 1.67 m²

Maid Toilet
2.13 × 1.03 m²

Lobby 01
1.28 × 5.99 m²

Lobby 02
1.30 × 1.82 m²

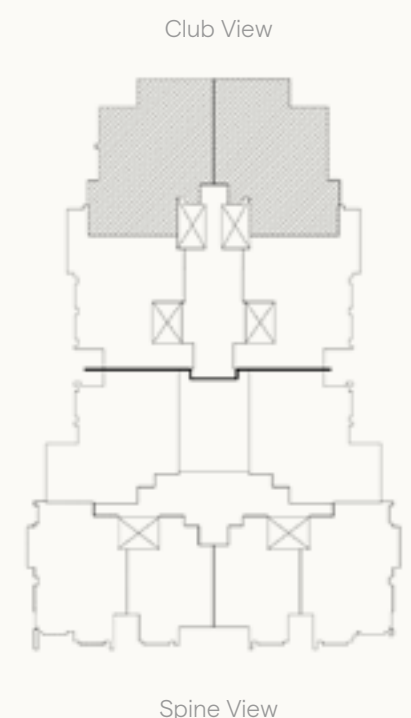

Disclaimer:

1.All dimensions will be measured from axis to axis. 2.All materials,dimensions and drawings are approximate information is subject to change without notice. 3.Actual area may vary from the stated area. 4.Drawing areas not to scale. 5.The developer reserves the right to make revisions. 6.Actual unit areas, front windows, porches, terraces,loggia and exterior trim detail may vary by elevation styles.

S - PREMIUM APARTMENT A-23/24

Available on Second Floor.	Total Area 190 m²	Terrace 01 2.15 × 6.60 m²	Terrace 02 0.30 × 2.44 m²
	Terrace 03 0.30 × 2.44 m²	Terrace 04 1.05 × 2.10 m²	

Entrance
1.52 × 2.26 m²

Reception
8.66 × 4.07 m²

Living
3.78 × 3.73 m²

Kitchen
3.19 × 3.34 m²

Master Bedroom
3.91 × 4.09 m²

M. Bathroom
2.00 × 2.75 m²

Dressing
2.11 × 2.75 m²

Bedroom 01
3.91 × 3.91 m²

Bedroom 02
3.91 × 3.72 m²

Guest Toilet
1.58 × 1.97 m²

Bathroom
1.92 × 2.50 m²

Lobby 01
1.28 × 1.36 m²

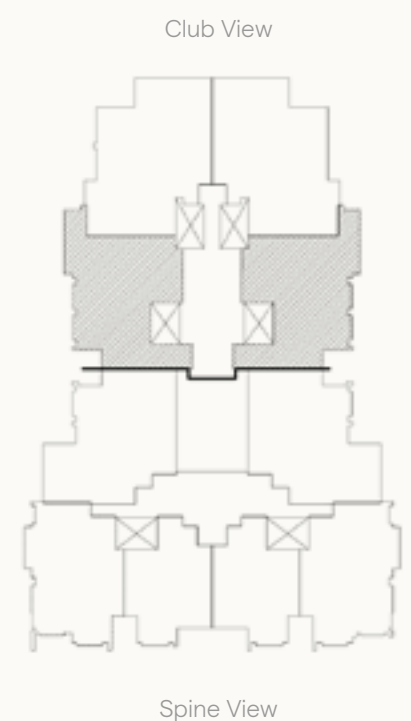

Disclaimer:

1.All dimensions will be measured from axis to axis. 2.All materials,dimensions and drawings are approximate information is subject to change without notice. 3.Actual area may vary from the stated area. 4.Drawing areas not to scale. 5.The developer reserves the right to make revisions. 6.Actual unit areas, front windows, porches, terraces,loggia and exterior trim detail may vary by elevation styles.

S - PREMIUM APARTMENT B-21/22

Available on Second Floor.	Total Area 190 m²	Terrace 01 1.05 × 1.66 m²
	Terrace 02 0.30 × 2.44 m²	Terrace 03 3.32 × 5.93 m²

Entrance
1.79 × 2.81 m²

Dressing
2.74 × 2.38 m²

Reception
7.75 × 4.36 m²

Bedroom 01
3.91 × 3.91 m²

Guest Toilet
2.74 × 1.32 m²

Bedroom 02
3.91 × 3.72 m²

Kitchen
2.80 × 3.11 m²

Bathroom
2.74 × 1.89 m²

Living
3.66 × 3.72 m²

Lobby 01
3.72 × 1.28 m²

Master Bedroom
3.91 × 4.29 m²

M. Bathroom
2.74 × 1.91 m²

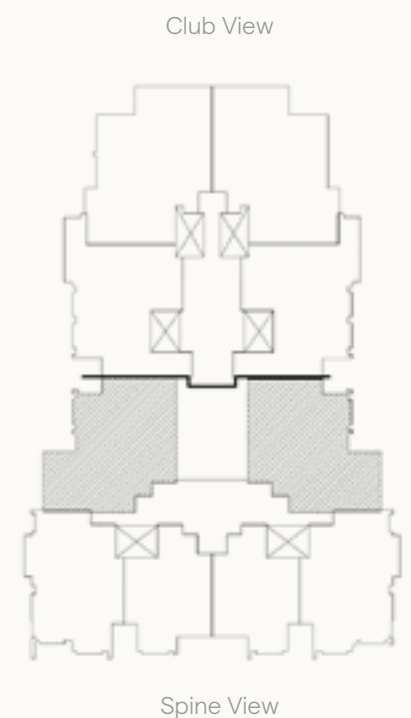

Disclaimer:

1.All dimensions will be measured from axis to axis. 2.All materials,dimensions and drawings are approximate information is subject to change without notice. 3.Actual area may vary from the stated area. 4.Drawing areas not to scale. 5.The developer reserves the right to make revisions. 6.Actual unit areas, front windows, porches, terraces,loggia and exterior trim detail may vary by elevation styles.

S - CORNER APARTMENT B-23/26

Available on Second Floor.	Total Area 160 m²	Terrace 01 1.10 × 4.20 m²	Terrace 02 0.30 × 1.64 m²
	Terrace 03 0.30 × 2.44 m²	Terrace 04 0.30 × 2.44 m²	Terrace 05 1.42 × 1.00 m²

Entrance 1.81 × 2.74 m ²	Bedroom 02 3.93 × 3.72 m ²
Reception 3.91 × 6.89 m ²	Guest Toilet 2.72 × 1.35 m ²
Kitchen 3.06 × 2.10 m ²	Bathroom 2.52 × 1.82 m ²
Master Bedroom 4.30 × 4.11 m ²	Lobby 01 1.92 × 2.50 m ²
M. Bathroom 2.11 × 2.42 m ²	Lobby 02 1.41 × 1.22 m ²
Dressing 1.80 × 2.42 m ²	
Bedroom 01 3.93 × 3.72 m ²	

Disclaimer:
 1.All dimensions will be measured from axis to axis. 2.All materials,dimensions and drawings are approximate information is subject to change without notice. 3.Actual area may vary from the stated area. 4.Drawing areas not to scale. 5.The developer reserves the right to make revisions. 6.Actual unit areas, front windows, porches, terraces,loggia and exterior trim detail may vary by elevation styles.

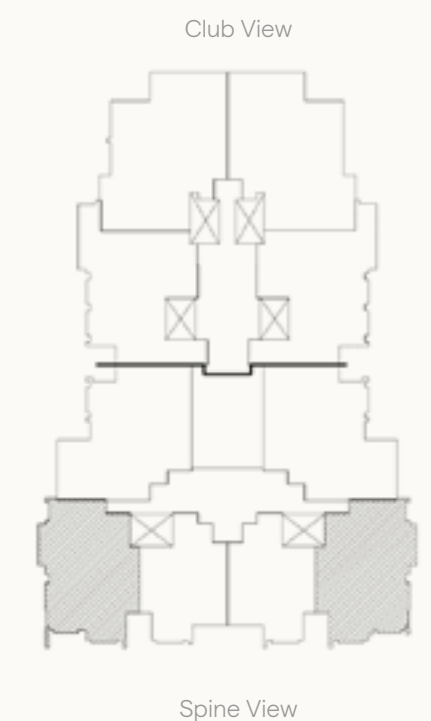

S - TYPICAL APARTMENT B-24/25

Available on
Second Floor.

Total Area
115 m²

Terrace 01
3.72 × 1.40 m²

Terrace 02
1.42 × 1.00 m²

Terrace 03
2.74 × 0.30 m²

Entrance
1.49 X 2.22 m²

M. Bathroom
2.59 X 1.88 m²

Reception
3.79 X 6.78 m²

Bedroom 01
3.85 X 3.85 m²

Kitchen
2.50 X 3.45 m²

Bathroom
2.62 X 1.82 m²

Master Bedroom
3.89 X 3.91 m²

Lobby
1.32 X 2.72 m²

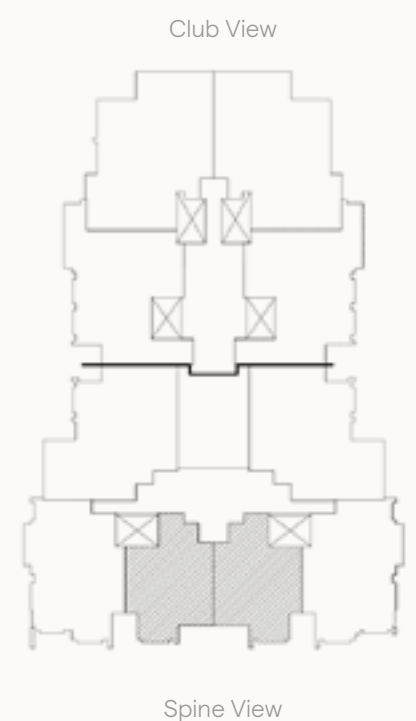

Disclaimer:

1.All dimensions will be measured from axis to axis. 2.All materials,dimensions and drawings are approximate information is subject to change without notice. 3.Actual area may vary from the stated area. 4.Drawing areas not to scale. 5.The developer reserves the right to make revisions. 6.Actual unit areas, front windows, porches, terraces,loggia and exterior trim detail may vary by elevation styles.

BUILDING S

RESIDENCE
EIGHT

Third Floor

Disclaimer

1.All dimensions will be measured from axis to axis. 2.All materials,dimensions and drawings are approximate information is subject to change without notice. 3.Actual area may vary from the stated area. 4.Drawing areas not to scale. 5.The developer reserves the right to make revisions. 6.Actual unit areas, front windows, porches, terraces,loggia and exterior trim detail may vary by elevation styles.



S - DELUXE APARTMENT A-31/32

Available on Third Floor. Total Area **210 m²** Terrace 01 **1.20 × 1.75 m²** Terrace 02 **7.9 × 1.82 m²**

Entrance 2.36 × 1.51 m ²	Bedroom 01 3.72 × 3.91 m ²
Reception 3.99 × 7.24 m ²	Bedroom 02 4.11 × 3.91 m ²
Dinning 2.50 × 3.33 m ²	Bedroom 03 4.11 × 3.72 m ²
Kitchen 3.11 × 3.70 m ²	Guest Toilet 2.36 × 1.27 m ²
Master Bedroom 5.31 × 3.80 m ²	Bathroom 2.81 × 1.82 m ²
M. Bathroom 1.88 × 2.30 m ²	Lobby 01 1.28 × 3.72 m ²
Dressing 2.10 × 2.30 m ²	Lobby 02 2.58 × 1.82 m ²

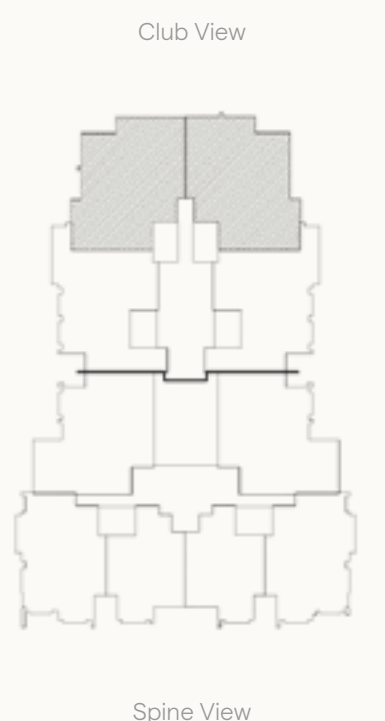

Disclaimer:
 1.All dimensions will be measured from axis to axis. 2.All materials,dimensions and drawings are approximate information is subject to change without notice. 3.Actual area may vary from the stated area. 4.Drawing areas not to scale. 5.The developer reserves the right to make revisions. 6.Actual unit areas, front windows, porches, terraces,loggia and exterior trim detail may vary by elevation styles.

S - PREMIUM APARTMENT A-33/34

Available on Third Floor.	Total Area 190 m²	Terrace 01 2.15 × 6.60 m²	Terrace 02 0.30 × 2.44 m²
	Terrace 03 0.30 × 2.44 m²	Terrace 04 1.05 × 2.10 m²	

Entrance
1.52 × 2.26 m²

Dressing
2.11 × 2.75 m²

Reception
8.66 × 4.07 m²

Bedroom 01
3.91 × 3.91 m²

Living
3.78 × 3.73 m²

Bedroom 02
3.91 × 3.72 m²

Kitchen
3.19 × 3.34 m²

Guest Toilet
1.58 × 1.97 m²

Master Bedroom
3.91 × 4.09 m²

Bathroom
1.92 × 2.50 m²

M. Bathroom
2.11 × 2.75 m²

Lobby 01
1.28 × 1.36 m²

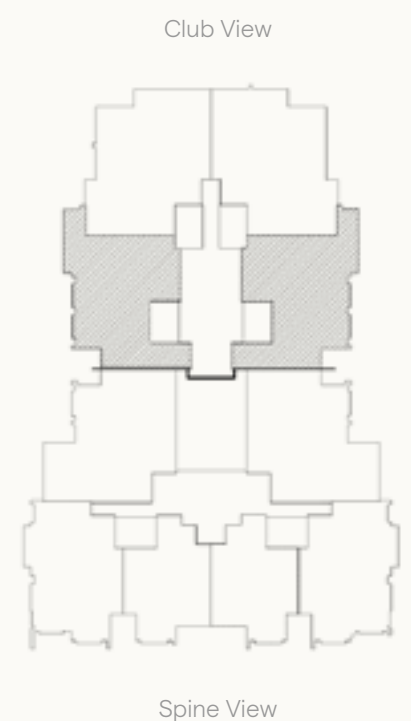

Disclaimer:

1.All dimensions will be measured from axis to axis. 2.All materials,dimensions and drawings are approximate information is subject to change without notice. 3.Actual area may vary from the stated area. 4.Drawing areas not to scale. 5.The developer reserves the right to make revisions. 6.Actual unit areas, front windows, porches, terraces,loggia and exterior trim detail may vary by elevation styles.

S - TERRACE APARTMENT B-31/32

Available on Third Floor.	Total Area 195 m²	Terrace 01 1.05 × 1.66 m²	Terrace 02 0.30 × 2.44 m²
	Terrace 03 3.32 × 5.93 m²	Terrace 04 2.44 × 3.34 m²	

Entrance
7.72 × 4.49 m²

Bedroom 02
3.85 × 4.10 m²

Kitchen
2.74 × 3.11 m²

Guest Toilet
2.74 × 1.32 m²

Master Bedroom
3.91 × 4.29 m²

Bathroom
2.74 × 1.89 m²

M. Bathroom
2.74 × 1.92 m²

Lobby 01
1.28 × 3.78 m²

Dressing
2.74 × 1.92 m²

Lobby 02
2.56 × 1.22 m²

Bedroom 01
3.91 × 3.72 m²

Reception
7.72 × 4.49 m²

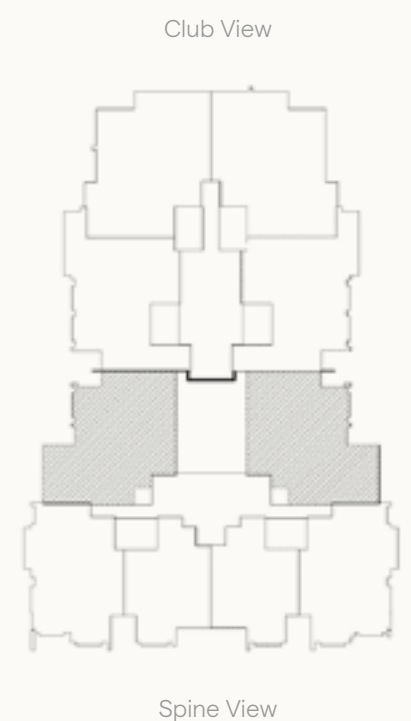

Disclaimer:

1.All dimensions will be measured from axis to axis. 2.All materials,dimensions and drawings are approximate information is subject to change without notice. 3.Actual area may vary from the stated area. 4.Drawing areas not to scale. 5.The developer reserves the right to make revisions. 6.Actual unit areas, front windows, porches, terraces,loggia and exterior trim detail may vary by elevation styles.

S - CORNER APARTMENT B-33/36

Available on Third Floor.	Total Area 160 m²	Terrace 01 1.10 × 4.20 m²	Terrace 02 0.30 × 1.64 m²
	Terrace 03 0.30 × 2.44 m²	Terrace 04 0.30 × 2.44 m²	Terrace 05 1.42 × 1.00 m²

Entrance
1.81 x 2.74 m²

Bedroom 01
3.93 x 3.72 m²

Reception
3.91 x 6.89 m²

Bedroom 02
3.79 x 3.91 m²

Kitchen
3.06 x 2.10 m²

Guest Toilet
2.72 x 1.35 m²

Master Bedroom
4.30 x 4.11 m²

Bathroom
2.52 x 1.82 m²

M. Bathroom
2.11 x 2.42 m²

Lobby 01
1.28 x 7.64 m²

Dressing
1.80 x 2.42 m²

Lobby 02
1.41 x 1.22 m²

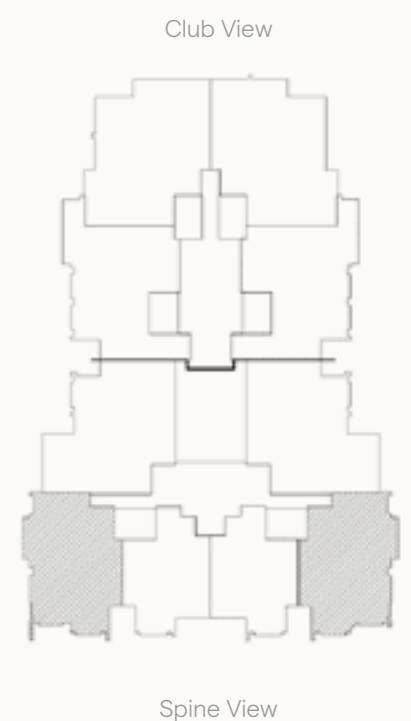

Disclaimer:

1.All dimensions will be measured from axis to axis. 2.All materials,dimensions and drawings are approximate information is subject to change without notice. 3.Actual area may vary from the stated area. 4.Drawing areas not to scale. 5.The developer reserves the right to make revisions. 6.Actual unit areas, front windows, porches, terraces,loggia and exterior trim detail may vary by elevation styles.

S - TYPICAL APARTMENT B-34/35

Available on Third Floor.	Total Area 115 m²	Terrace 01 3.72 × 1.40 m²	Terrace 02 1.42 × 1.00 m²
	Terrace 03 2.74 × 0.30 m²		

Entrance
1.49 X 2.22 m²

M. Bathroom
2.59 X 1.88 m²

Reception
3.79 X 6.78 m²

Bedroom 01
3.85 X 3.85 m²

Kitchen
2.50 X 3.45 m²

Bathroom
2.62 X 1.82 m²

Master Bedroom
3.89 X 3.91 m²

Lobby
1.32 X 2.72 m²



Disclaimer:

1.All dimensions will be measured from axis to axis. 2.All materials,dimensions and drawings are approximate information is subject to change without notice. 3.Actual area may vary from the stated area. 4.Drawing areas not to scale. 5.The developer reserves the right to make revisions. 6.Actual unit areas, front windows, porches, terraces,loggia and exterior trim detail may vary by elevation styles.

BUILDING S

RESIDENCE
EIGHT

Fourth Floor

Disclaimer

1.All dimensions will be measured from axis to axis. 2.All materials,dimensions and drawings are approximate information is subject to change without notice. 3.Actual area may vary from the stated area. 4.Drawing areas not to scale. 5.The developer reserves the right to make revisions. 6.Actual unit areas, front windows, porches, terraces,loggia and exterior trim detail may vary by elevation styles.



S - DELUXE APARTMENT A-41/42

Available on Fourth Floor. Total Area **200 m²** Terrace 01 **1.20 × 1.75 m²** Terrace 02 **3.85 × 1.42 m²**

Entrance 2.36 × 1.51 m² Bedroom 02 4.11 × 3.91 m²

Reception 3.99 × 7.24 m² Bedroom 03 4.11 × 3.72 m²

Dinning 2.50 × 3.33 m² Guest Toilet 2.36 × 1.33 m²

Kitchen 3.11 × 3.70 m² Bathroom 2.81 × 1.82 m²

Master Bedroom 5.31 × 3.80 m² M. Bathroom 1.88 × 2.30 m²

Dressing 2.10 × 2.30 m² Lobby 01 1.28 × 3.72 m²

Bedroom 01 3.72 × 3.91 m² Lobby 02 2.58 × 1.82 m²

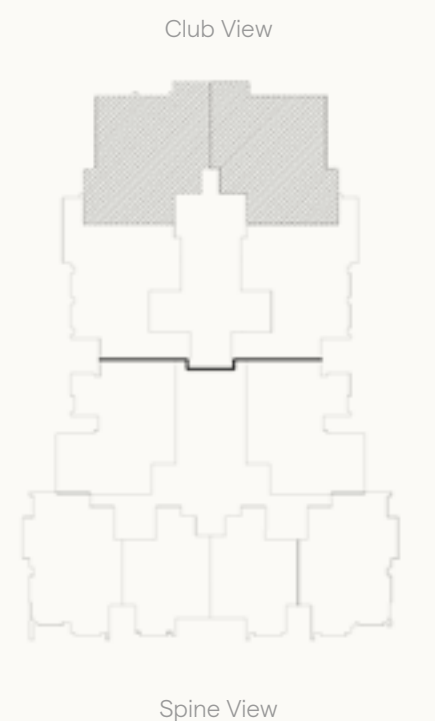

Disclaimer:

1.All dimensions will be measured from axis to axis. 2.All materials,dimensions and drawings are approximate information is subject to change without notice. 3.Actual area may vary from the stated area. 4.Drawing areas not to scale. 5.The developer reserves the right to make revisions. 6.Actual unit areas, front windows, porches, terraces,loggia and exterior trim detail may vary by elevation styles.

S - PREMIUM APARTMENT A-43/44

Available on Fourth Floor.	Total Area 190 m²	Terrace 01 2.15 × 6.60 m²	Terrace 02 0.30 × 2.44 m²
	Terrace 03 0.30 × 2.44 m²	Terrace 04 1.05 × 2.10 m²	

Entrance
1.52 × 2.26 m²

Bedroom 01
3.91 × 3.91 m²

Reception
8.66 × 4.07 m²

Bedroom 02
3.91 × 3.72 m²

Living
3.78 × 3.73 m²

Guest Toilet
1.58 × 1.97 m²

Kitchen
3.19 × 3.34 m²

Bathroom
1.92 × 2.50 m²

Master Bedroom
3.91 × 4.09 m²

M. Bathroom
2.00 × 2.75 m²

Dressing
2.11 × 2.75 m²

Lobby 01
1.28 × 1.36 m²

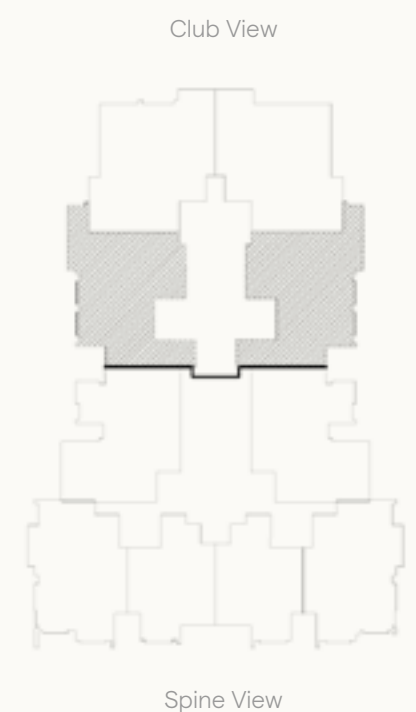

Disclaimer:

1.All dimensions will be measured from axis to axis. 2.All materials,dimensions and drawings are approximate information is subject to change without notice. 3.Actual area may vary from the stated area. 4.Drawing areas not to scale. 5.The developer reserves the right to make revisions. 6.Actual unit areas, front windows, porches, terraces,loggia and exterior trim detail may vary by elevation styles.

S - TERRACE APARTMENT B-41/42

Available on Fourth Floor.	Total Area 180 m²	Terrace 01 1.05 × 1.66 m²	Terrace 02 0.30 × 2.47 m²
	Terrace 03 1.82 × 5.93 m²	Terrace 04 2.44 × 1.50 m²	

Reception
7.72 × 4.49 m²

Guest Toilet
2.74 × 1.32 m²

Kitchen
2.74 × 3.11 m²

Bathroom
2.74 × 1.89 m²

Master Bedroom
3.91 × 4.29 m²

M. Bathroom
2.74 × 1.92 m²

Dressing
2.74 × 2.37 m²

Lobby 01
1.28 × 3.78 m²

Bedroom 01
3.91 × 3.72 m²

Lobby 02
2.56 × 1.22 m²

Bedroom 02
3.85 × 4.10 m²

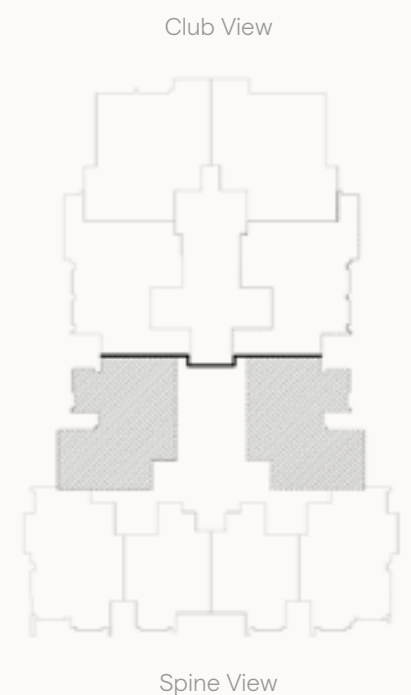

Disclaimer:

1.All dimensions will be measured from axis to axis. 2.All materials,dimensions and drawings are approximate information is subject to change without notice. 3.Actual area may vary from the stated area. 4.Drawing areas not to scale. 5.The developer reserves the right to make revisions. 6.Actual unit areas, front windows, porches, terraces,loggia and exterior trim detail may vary by elevation styles.

S - CORNER APARTMENT B-43/46

Available on Fourth Floor.	Total Area 160 m²	Terrace 01 1.10 × 4.20 m²	Terrace 02 0.30 × 1.64 m²
	Terrace 03 0.30 × 2.44 m²	Terrace 04 0.30 × 2.44 m²	Terrace 05 1.00 × 1.42 m²

Entrance 1.81 × 2.74 m ²	Bedroom 02 3.79 × 3.91 m ²
Reception 3.91 × 6.89 m ²	Guest Toilet 2.72 × 1.35 m ²
Kitchen 3.06 × 2.10 m ²	Bathroom 2.52 × 1.82 m ²
Master Bedroom 4.30 × 4.11 m ²	M. Bathroom 2.11 × 2.42 m ²
Dressing 1.80 × 2.42 m ²	Lobby 01 1.28 × 7.64 m ²
Bedroom 01 3.93 × 3.72 m ²	Lobby 02 1.41 × 1.22 m ²

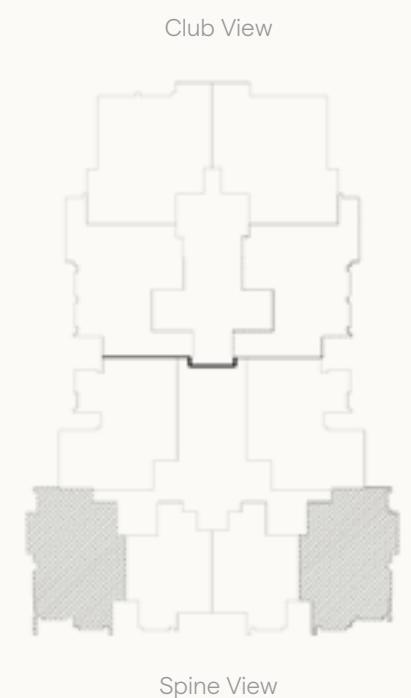

Disclaimer:
 1.All dimensions will be measured from axis to axis. 2.All materials,dimensions and drawings are approximate information is subject to change without notice. 3.Actual area may vary from the stated area. 4.Drawing areas not to scale. 5.The developer reserves the right to make revisions. 6.Actual unit areas, front windows, porches, terraces,loggia and exterior trim detail may vary by elevation styles.

S - TYPICAL APARTMENT B-44/45

Available on Fourth Floor.	Total Area 115 m²	Terrace 01 3.72 × 1.40 m²
	Terrace 02 1.42 × 1.00 m²	Terrace 03 2.74 × 0.30 m²

Entrance 1.49 × 2.22 m ²	Bedroom 01 3.85 × 3.85 m ²
Reception 3.79 × 6.78 m ²	Bathroom 2.62 × 1.82 m ²
Kitchen 2.50 × 3.45 m ²	Lobby 01 2.62 × 1.82 m ²
Master Bedroom 3.89 × 3.91 m ²	

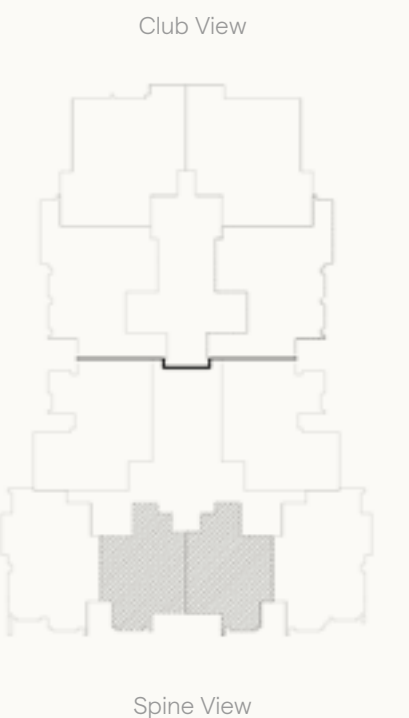

Disclaimer:
 1.All dimensions will be measured from axis to axis. 2.All materials,dimensions and drawings are approximate information is subject to change without notice. 3.Actual area may vary from the stated area. 4.Drawing areas not to scale. 5.The developer reserves the right to make revisions. 6.Actual unit areas, front windows, porches, terraces,loggia and exterior trim detail may vary by elevation styles.

BUILDING S

RESIDENCE
EIGHT

Fifth Floor

Disclaimer

1.All dimensions will be measured from axis to axis. 2.All materials,dimensions and drawings are approximate information is subject to change without notice. 3.Actual area may vary from the stated area. 4.Drawing areas not to scale. 5.The developer reserves the right to make revisions. 6.Actual unit areas, front windows, porches, terraces,loggia and exterior trim detail may vary by elevation styles.



S - DELUXE APARTMENT A-51/52

Available on Fifth Floor. Total Area **200 m²** Terrace 01 **1.20 × 1.75 m²** Terrace 02 **3.85 × 1.42 m²**

Entrance 2.36 × 1.51 m² Bedroom 02 4.11 × 3.91 m²

Reception 3.99 × 7.24 m² Bedroom 03 4.11 × 3.72 m²

Dinning 2.50 × 3.33 m² Guest Toilet 2.36 × 1.33 m²

Kitchen 3.11 × 3.70 m² Bathroom 2.81 × 1.82 m²

Master Bedroom 5.31 × 3.80 m² M. Bathroom 1.88 × 2.30 m²

Dressing 2.10 × 2.30 m² Lobby 01 1.28 × 3.72 m²

Bedroom 01 3.72 × 3.91 m² Lobby 02 2.58 × 1.82 m²

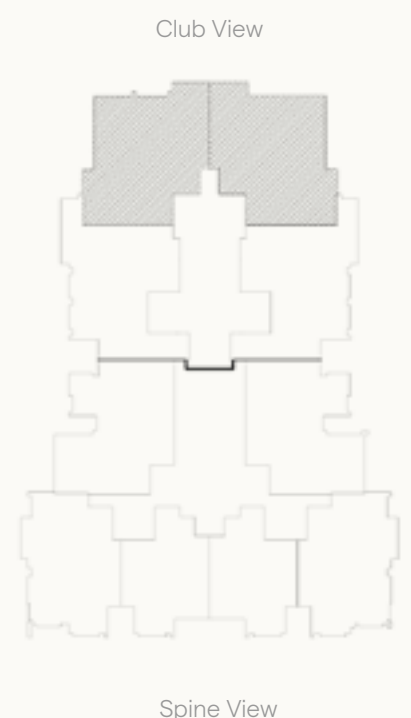

Disclaimer:

1.All dimensions will be measured from axis to axis. 2.All materials,dimensions and drawings are approximate information is subject to change without notice. 3.Actual area may vary from the stated area. 4.Drawing areas not to scale. 5.The developer reserves the right to make revisions. 6.Actual unit areas, front windows, porches, terraces,loggia and exterior trim detail may vary by elevation styles.

S - PREMIUM APARTMENT A-53/54

Available on Fifth Floor.	Total Area 190 m²	Terrace 01 2.15 × 6.60 m²	Terrace 02 0.30 × 2.44 m²
	Terrace 03 0.30 × 2.44 m²	Terrace 04 1.05 × 2.10 m²	

Entrance
1.52 × 2.26 m²

Bedroom 01
3.91 × 3.91 m²

Reception
8.66 × 4.07 m²

Bedroom 02
3.91 × 3.72 m²

Living
3.78 × 3.73 m²

Guest Toilet
1.58 × 1.97 m²

Kitchen
3.19 × 3.34 m²

Bathroom
1.92 × 2.50 m²

Master Bedroom
3.91 × 4.09 m²

M. Bathroom
2.00 × 2.75 m²

Dressing
2.11 × 2.75 m²

Lobby 01
1.28 × 1.36 m²



Disclaimer:

1.All dimensions will be measured from axis to axis. 2.All materials,dimensions and drawings are approximate information is subject to change without notice. 3.Actual area may vary from the stated area. 4.Drawing areas not to scale. 5.The developer reserves the right to make revisions. 6.Actual unit areas, front windows, porches, terraces,loggia and exterior trim detail may vary by elevation styles.

S - TERRACE APARTMENT B-51/52

Available on Fifth Floor.	Total Area 180 m²	Terrace 01 1.05 × 1.66 m²	Terrace 02 0.30 × 2.47 m²
	Terrace 03 1.82 × 5.93 m²	Terrace 04 2.44 × 1.50 m²	

Reception
7.72 × 4.49 m²

Guest Toilet
2.74 × 1.32 m²

Kitchen
2.74 × 3.11 m²

Bathroom
2.74 × 1.89 m²

Master Bedroom
3.91 × 4.29 m²

M. Bathroom
2.74 × 1.91 m²

Dressing
2.74 × 2.38 m²

Lobby 01
1.28 × 3.78 m²

Bedroom 01
3.91 × 3.72 m²

Lobby 02
2.56 × 1.22 m²

Bedroom 02
3.85 × 4.10 m²

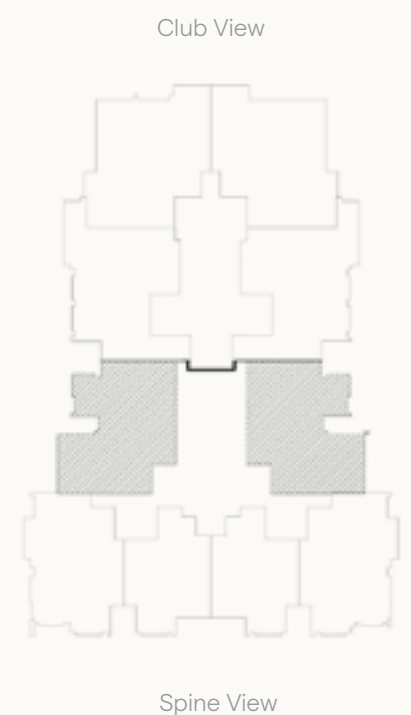

Disclaimer:

1.All dimensions will be measured from axis to axis. 2.All materials,dimensions and drawings are approximate information is subject to change without notice. 3.Actual area may vary from the stated area. 4.Drawing areas not to scale. 5.The developer reserves the right to make revisions. 6.Actual unit areas, front windows, porches, terraces,loggia and exterior trim detail may vary by elevation styles.

S - CORNER APARTMENT B-53/56

Available on Fifth Floor.	Total Area 160 m²	Terrace 01 1.10 × 4.20 m²	Terrace 02 1.00 × 1.42 m²
	Terrace 03 0.30 × 2.44 m²	Terrace 04 0.30 × 2.44 m²	Terrace 05 0.30 × 1.64 m²

Entrance
1.81 × 2.74 m²

Bedroom 02
3.79 × 3.91 m²

Reception
3.91 × 6.89 m²

Guest Toilet
2.72 × 1.35 m²

Kitchen
3.06 × 2.10 m²

Bathroom
2.52 × 1.82 m²

Master Bedroom
4.30 × 4.11 m²

M. Bathroom
2.11 × 2.42 m²

Dressing
1.80 × 2.42 m²

Lobby 01
1.28 × 7.64 m²

Bedroom 01
3.93 × 3.72 m²

Lobby 02
1.41 × 1.22 m²

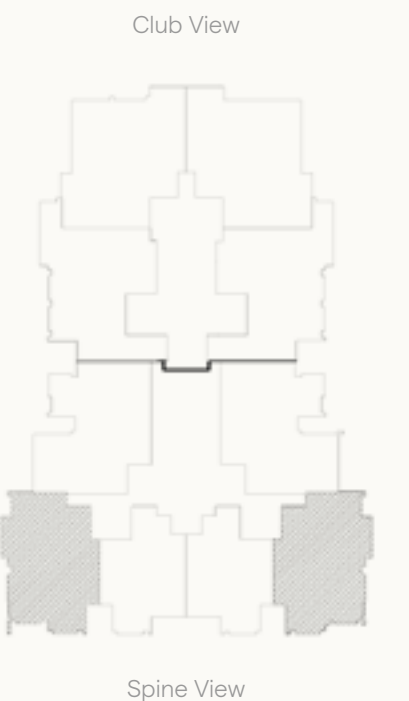

Disclaimer:

1.All dimensions will be measured from axis to axis. 2.All materials,dimensions and drawings are approximate information is subject to change without notice. 3.Actual area may vary from the stated area. 4.Drawing areas not to scale. 5.The developer reserves the right to make revisions. 6.Actual unit areas, front windows, porches, terraces,loggia and exterior trim detail may vary by elevation styles.

S - TYPICAL APARTMENT B-54/55

Available on Fifth Floor.	Total Area 115 m²	Terrace 01 3.72 × 1.40 m²
	Terrace 02 1.42 × 1.00 m²	Terrace 03 2.74 × 0.30 m²

Entrance 1.49 × 2.22 m ²	M. Bathroom 2.59 × 1.88 m ²
Reception 3.79 × 6.78 m ²	Bedroom 01 3.85 × 3.85 m ²
Kitchen 2.50 × 3.45 m ²	Bathroom 2.62 × 1.82 m ²
Master Bedroom 3.89 × 3.91 m ²	Lobby 01 2.62 × 1.82 m ²

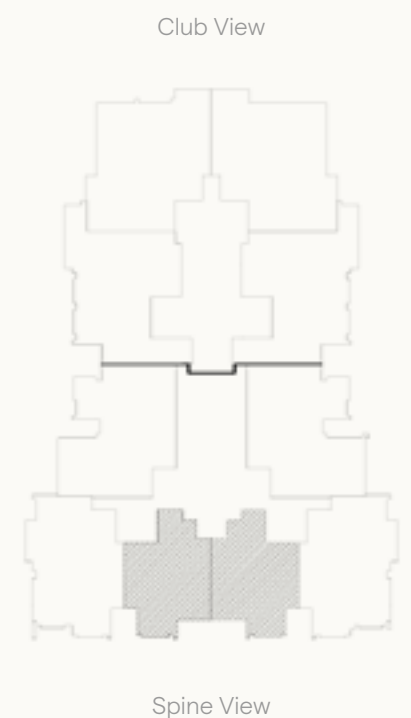

Disclaimer:
 1.All dimensions will be measured from axis to axis. 2.All materials,dimensions and drawings are approximate information is subject to change without notice. 3.Actual area may vary from the stated area. 4.Drawing areas not to scale. 5.The developer reserves the right to make revisions. 6.Actual unit areas, front windows, porches, terraces,loggia and exterior trim detail may vary by elevation styles.

BUILDING S

RESIDENCE
EIGHT

Sixth Floor

Disclaimer

1.All dimensions will be measured from axis to axis. 2.All materials,dimensions and drawings are approximate information is subject to change without notice. 3.Actual area may vary from the stated area. 4.Drawing areas not to scale. 5.The developer reserves the right to make revisions. 6.Actual unit areas, front windows, porches, terraces,loggia and exterior trim detail may vary by elevation styles.



S - SKY DUPLEX A-61/62

Available on Sixth Floor. Total Area **360 m²** Terrace 01 **8.09 × 2.36 m²** Terrace 02 **3.78 × 3.73 m²** Terrace 02 **1.20 × 1.75 m²**

Entrance 2.13 × 2.65 m² Laundry 1.28 × 1.78 m²

Reception 7.53 × 5.01 m² Maid Room 2.48 × 2.12 m²

Dinning 4.28 × 5.01 m² Maid Toilet 2.48 × 1.10 m²

Kitchen 4.09 × 5.87 m² Lobby 3.06 × 1.28 m²

Guest Toilet 1.91 × 1.37 m²

Terrace 01 **1.20 × 1.75 m²** Terrace 02 **3.73 × 1.20 m²**

Stair 2.68 X 5.87 m² Bedroom 01 3.98 X 5.01 m²

Master Bedroom 3.79 X 6.52 m² Bedroom 02 4.11 X 5.01 m²

Dressing 2.46 X 2.67 m² Bedroom 03 4.09 X 3.79 m²

M. Bathroom 2.52 X 1.92 m² Bathroom 2.89 X 2.08 m²

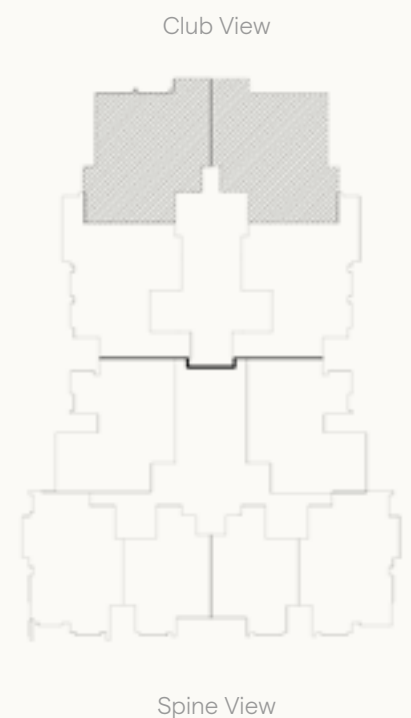

Disclaimer:

1.All dimensions will be measured from axis to axis. 2.All materials,dimensions and drawings are approximate information is subject to change without notice. 3.Actual area may vary from the stated area. 4.Drawing areas not to scale. 5.The developer reserves the right to make revisions. 6.Actual unit areas, front windows, porches, terraces,loggia and exterior trim detail may vary by elevation styles.

S - PREMIUM APARTMENT A-63/64

Available on Sixth Floor.	Total Area 190 m²	Terrace 01 2.15 × 6.60 m²	Terrace 02 0.30 × 2.44 m²
	Terrace 03 0.30 × 2.44 m²	Terrace 04 1.05 × 2.10 m²	

Entrance
1.52 × 2.26 m²

Bedroom 01
3.91 × 3.91 m²

Reception
8.66 × 4.07 m²

Bedroom 02
3.91 × 3.72 m²

Living
3.78 × 3.73 m²

Guest Toilet
1.58 × 1.97 m²

Kitchen
3.19 × 3.34 m²

Bathroom
1.92 × 2.50 m²

Master Bedroom
3.91 × 4.09 m²

M. Bathroom
2.00 × 2.75 m²

Dressing
2.11 × 2.75 m²

Lobby 01
1.28 × 1.36 m²



Disclaimer:

1.All dimensions will be measured from axis to axis. 2.All materials,dimensions and drawings are approximate information is subject to change without notice. 3.Actual area may vary from the stated area. 4.Drawing areas not to scale. 5.The developer reserves the right to make revisions. 6.Actual unit areas, front windows, porches, terraces,loggia and exterior trim detail may vary by elevation styles.

S - TERRACE APARTMENT B-61/62

Available on Sixth Floor.	Total Area 180 m²	Terrace 01 1.05 × 1.66 m²	Terrace 02 0.30 × 2.47 m²
	Terrace 03 1.82 × 5.93 m²	Terrace 04 2.44 × 1.50 m²	

Reception
7.72 × 4.49 m²

Guest Toilet
2.74 × 1.32 m²

Kitchen
2.74 × 3.11 m²

Bathroom
2.74 × 1.89 m²

Master Bedroom
3.91 × 4.29 m²

M. Bathroom
2.74 × 1.91 m²

Dressing
2.74 × 2.37 m²

Lobby 01
1.28 × 3.78 m²

Bedroom 01
3.91 × 3.72 m²

Lobby 02
2.56 × 1.22 m²

Bedroom 02
3.85 × 4.10 m²

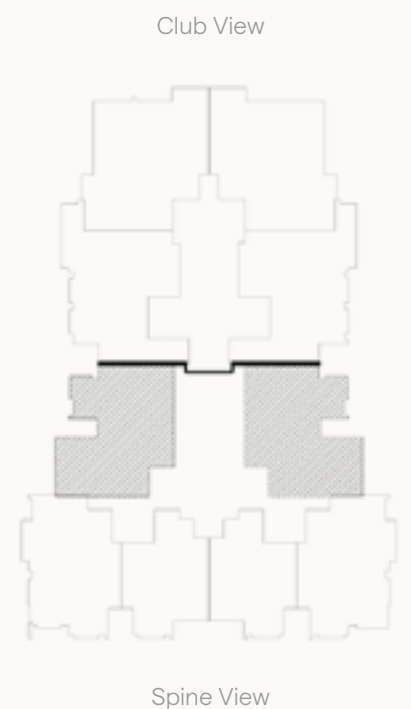

Disclaimer:

1.All dimensions will be measured from axis to axis. 2.All materials,dimensions and drawings are approximate information is subject to change without notice. 3.Actual area may vary from the stated area. 4.Drawing areas not to scale. 5.The developer reserves the right to make revisions. 6.Actual unit areas, front windows, porches, terraces,loggia and exterior trim detail may vary by elevation styles.

S - CORNER APARTMENT B-63/66

Available on Sixth Floor.	Total Area 160 m²	Terrace 01 1.10 × 4.20 m²	Terrace 02 0.30 × 1.64 m²
	Terrace 03 0.30 × 2.44 m²	Terrace 04 0.30 × 2.44 m²	Terrace 05 1.42 × 1.00 m²

Entrance 1.81 × 2.74 m ²	Bedroom 02 3.79 × 3.91 m ²
Reception 3.91 × 6.89 m ²	Guest Toilet 2.72 × 1.35 m ²
Kitchen 3.06 × 2.10 m ²	Bathroom 2.52 × 1.82 m ²
Master Bedroom 4.30 × 4.11 m ²	M. Bathroom 2.11 × 2.42 m ²
Dressing 1.80 × 2.42 m ²	Lobby 01 1.28 × 7.64 m ²
Bedroom 01 3.93 × 3.72 m ²	Lobby 02 1.41 × 1.22 m ²

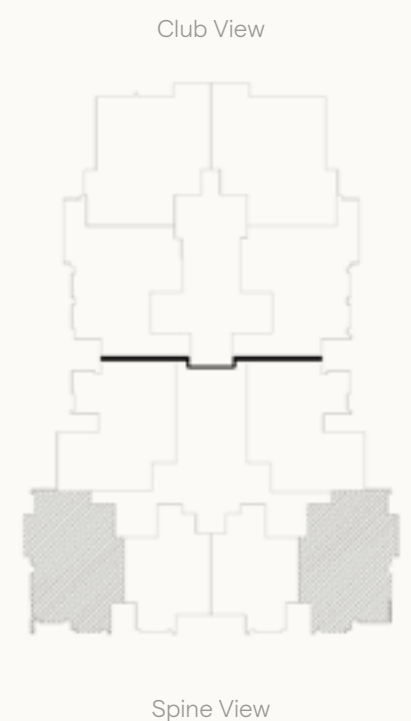

Disclaimer:

1.All dimensions will be measured from axis to axis. 2.All materials,dimensions and drawings are approximate information is subject to change without notice. 3.Actual area may vary from the stated area. 4.Drawing areas not to scale. 5.The developer reserves the right to make revisions. 6.Actual unit areas, front windows, porches, terraces,loggia and exterior trim detail may vary by elevation styles.

S - TYPICAL APARTMENT B-64/65

Available on Sixth Floor. Total Area **115 m²** Terrace 01 **3.72 × 1.40 m²**

Terrace 02 **1.42 × 1.00 m²** Terrace 03 **2.74 × 0.30 m²**

Entrance
1.49 × 2.22 m²

M. Bathroom
2.59 × 1.88 m²

Reception
3.79 × 6.78 m²

Bedroom 01
3.85 × 3.85 m²

Kitchen
2.50 × 3.45 m²

Bathroom
2.62 × 1.82 m²

Master Bedroom
3.89 × 3.91 m²

Lobby 01
1.32 × 2.72 m²

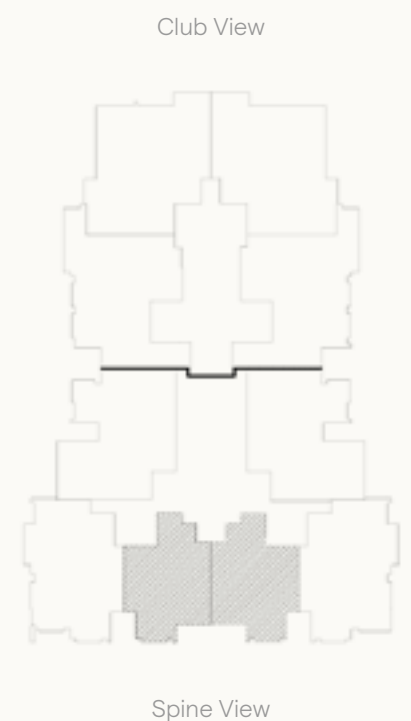

Disclaimer:

1.All dimensions will be measured from axis to axis. 2.All materials,dimensions and drawings are approximate information is subject to change without notice. 3.Actual area may vary from the stated area. 4.Drawing areas not to scale. 5.The developer reserves the right to make revisions. 6.Actual unit areas, front windows, porches, terraces,loggia and exterior trim detail may vary by elevation styles.

BUILDING S

RESIDENCE
EIGHT

Seventh Floor

Disclaimer

1.All dimensions will be measured from axis to axis. 2.All materials,dimensions and drawings are approximate information is subject to change without notice. 3.Actual area may vary from the stated area. 4.Drawing areas not to scale. 5.The developer reserves the right to make revisions. 6.Actual unit areas, front windows, porches, terraces,loggia and exterior trim detail may vary by elevation styles.



S - PREMIUM APARTMENT A-73/74

Available on Seventh Floor.	Total Area 190 m²	Terrace 01 2.15 × 6.60 m²	Terrace 02 0.30 × 2.44 m²
	Terrace 03 0.30 × 2.44 m²	Terrace 04 1.05 × 2.10 m²	

Entrance
1.52 × 2.26 m²

Bedroom 01
3.91 × 3.91 m²

Reception
8.66 × 4.07 m²

Bedroom 02
3.91 × 3.72 m²

Living
3.78 × 3.73 m²

Guest Toilet
1.58 × 1.97 m²

Kitchen
3.19 × 3.34 m²

Bathroom
1.92 × 2.50 m²

Master Bedroom
3.91 × 4.09 m²

M. Bathroom
2.00 × 2.75 m²

Dressing
2.11 × 2.75 m²

Lobby 01
1.28 × 1.36 m²

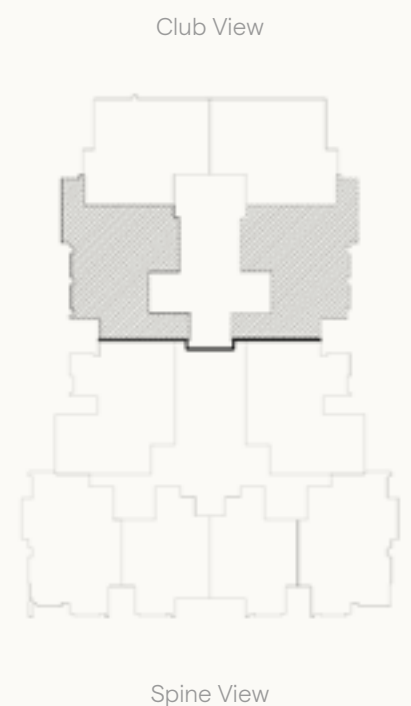

Disclaimer:

1.All dimensions will be measured from axis to axis. 2.All materials,dimensions and drawings are approximate information is subject to change without notice. 3.Actual area may vary from the stated area. 4.Drawing areas not to scale. 5.The developer reserves the right to make revisions. 6.Actual unit areas, front windows, porches, terraces,loggia and exterior trim detail may vary by elevation styles.

S - TERRACE APARTMENT B-71/72

Available on Seventh Floor.	Total Area 180 m²	Terrace 01 1.05 × 1.66 m²	Terrace 02 0.30 × 2.47 m²
	Terrace 03 1.82 × 5.93 m²	Terrace 04 2.31 × 1.50 m²	

Reception
7.72 × 4.49 m²

Guest Toilet
2.74 × 1.32 m²

Kitchen
2.74 × 3.11 m²

Bathroom
2.74 × 1.89 m²

Master Bedroom
3.91 × 4.29 m²

M. Bathroom
2.74 × 1.92 m²

Dressing
2.74 × 2.37 m²

Lobby 01
1.28 × 3.78 m²

Bedroom 01
3.91 × 3.72 m²

Lobby 02
2.56 × 1.22 m²

Bedroom 02
3.85 × 4.10 m²

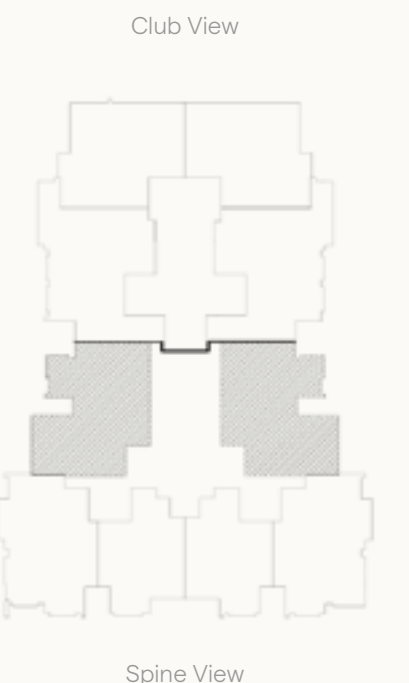

Disclaimer:
 1.All dimensions will be measured from axis to axis. 2.All materials,dimensions and drawings are approximate information is subject to change without notice. 3.Actual area may vary from the stated area. 4.Drawing areas not to scale. 5.The developer reserves the right to make revisions. 6.Actual unit areas, front windows, porches, terraces,loggia and exterior trim detail may vary by elevation styles.

S - CORNER APARTMENT B-73/76

Available on Seventh Floor.	Total Area 160 m²	Terrace 01 1.10 × 4.20 m²	Terrace 02 0.30 × 1.46 m²
	Terrace 03 0.30 × 2.44 m²	Terrace 04 0.30 × 2.44 m²	Terrace 05 1.42 × 1.00 m²

Entrance 1.81 × 2.74 m ²	Bedroom 02 3.79 × 3.91 m ²
Reception 3.91 × 6.89 m ²	Guest Toilet 2.72 × 1.35 m ²
Kitchen 3.06 × 2.10 m ²	Bathroom 2.52 × 1.82 m ²
Master Bedroom 4.30 × 4.11 m ²	M. Bathroom 2.11 × 2.42 m ²
Dressing 1.80 × 2.42 m ²	Lobby 01 1.28 × 7.64 m ²
Bedroom 01 3.93 × 3.72 m ²	Lobby 02 1.41 × 1.22 m ²

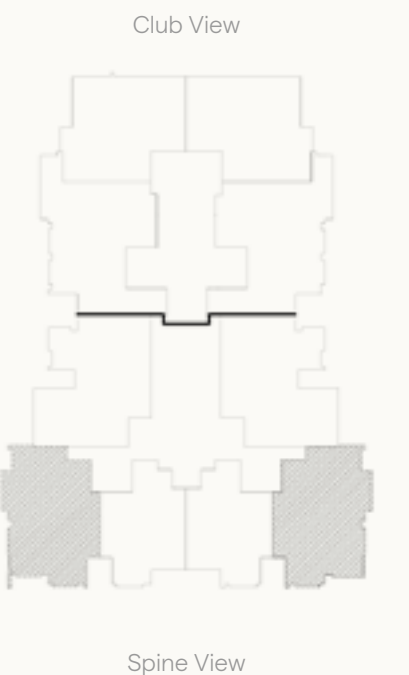

Disclaimer:
 1.All dimensions will be measured from axis to axis. 2.All materials,dimensions and drawings are approximate information is subject to change without notice. 3.Actual area may vary from the stated area. 4.Drawing areas not to scale. 5.The developer reserves the right to make revisions. 6.Actual unit areas, front windows, porches, terraces,loggia and exterior trim detail may vary by elevation styles.

S - TYPICAL APARTMENT A-74/75

Available on Seventh Floor. **Total Area 115 m²**

Terrace 01 **3.72 × 1.40 m²**

Terrace 02 **1.42 × 1.00 m²**

Terrace 03 **2.74 × 0.30 m²**

Entrance 1.49 × 2.22 m²

M. Bathroom 2.59 × 1.88 m²

Reception 3.79 × 6.78 m²

Bedroom 01 3.85 × 3.85 m²

Kitchen 2.50 × 3.45 m²

Bathroom 2.62 × 1.82 m²

Master Bedroom 3.89 × 3.91 m²

Lobby 01 1.32 × 2.72 m²

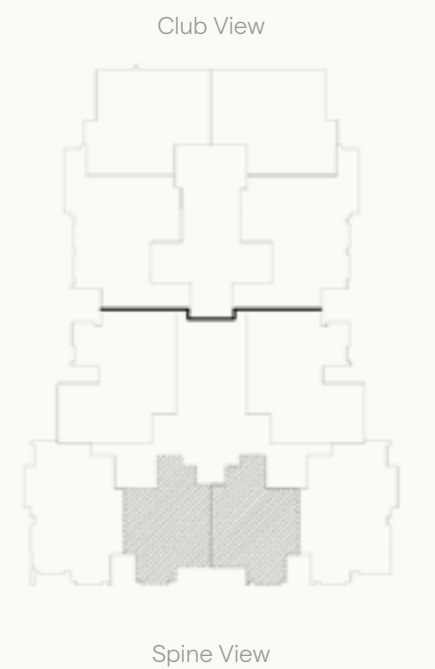

Disclaimer:
 1.All dimensions will be measured from axis to axis. 2.All materials,dimensions and drawings are approximate information is subject to change without notice. 3.Actual area may vary from the stated area. 4.Drawing areas not to scale. 5.The developer reserves the right to make revisions. 6.Actual unit areas, front windows, porches, terraces,loggia and exterior trim detail may vary by elevation styles.

BUILDING K

RESIDENCE
EIGHT

Ground Floor

Disclaimer

1.All dimensions will be measured from axis to axis. 2.All materials,dimensions and drawings are approximate information is subject to change without notice. 3.Actual area may vary from the stated area. 4.Drawing areas not to scale. 5.The developer reserves the right to make revisions. 6.Actual unit areas, front windows, porches, terraces,loggia and exterior trim detail may vary by elevation style.



K - GARDEN APARTMENT A-1/2 B-3/4

Available on Ground Floor. Private Garden **45 m²** Total Area **150 m²**

Entrance 1.63 × 3.52 m² Bedroom 01 3.72 × 3.91 m²

Reception 4.41 × 6.51 m² Bedroom 02 3.91 × 3.91 m²

Guest Toilet 2.19 × 1.57 m² Master Bedroom 3.91 × 4.06 m²

Lobby 01 2.54 × 1.28 m² M. Bathroom 1.85 × 2.46 m²

Kitchen 2.74 × 1.28 m² Dressing 1.99 × 2.68 m²

Bathroom 2.11 × 2.75 m²

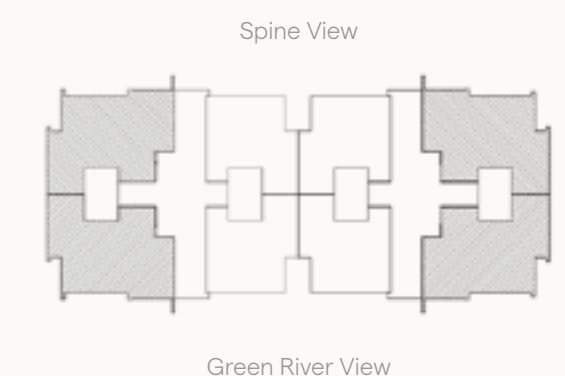

Disclaimer:

1.All dimensions will be measured from axis to axis. 2.All materials,dimensions and drawings are approximate information is subject to change without notice. 3.Actual area may vary from the stated area. 4.Drawing areas not to scale. 5.The developer reserves the right to make revisions. 6.Actual unit areas, front windows, porches, terraces,loggia and exterior trim detail may vary by elevation styles.

K - GARDEN APARTMENT A-3/4 B-1/2

Available on
Ground Floor. Private Garden
45 m² Total Area
110 m²

Reception
4.56 × 5.97 m²

Bedroom 01
3.91 × 3.91 m²

Lobby 01
1.25 × 1.52 m²

Master Bedroom
3.78 × 4.06 m²

Kitchen
3.33 × 3.19 m²

M. Bathroom
1.98 × 2.68 m²

Bathroom
2.73 × 2.22 m²

Dressing
1.86 × 2.68 m²

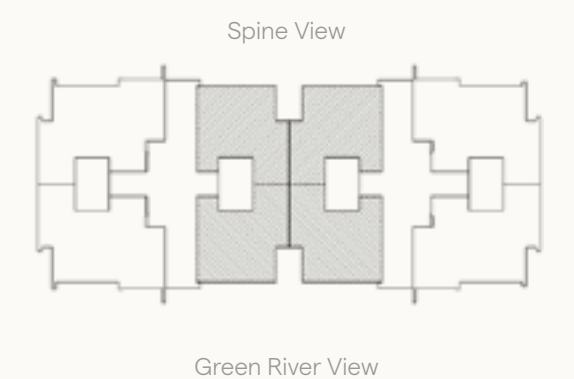

Disclaimer:

1.All dimensions will be measured from axis to axis. 2.All materials,dimensions and drawings are approximate information is subject to change without notice. 3.Actual area may vary from the stated area. 4.Drawing areas not to scale. 5.The developer reserves the right to make revisions. 6.Actual unit areas, front windows, porches, terraces,loggia and exterior trim detail may vary by elevation styles.

BUILDING K

RESIDENCE
EIGHT

First, Second, Fourth & Sixth Floors

K - TYPICAL APARTMENT

A-11/12/13/14 B-11/12/13/14

Available on First, Second, Fourth and Sixth Floor.

Total Area	Terrace 01
155 m²	2.44 × 0.30 m²
Terrace 02	Terrace 03
2.44 × 0.30 m²	3.83 × 1.50 m²

Entrance
1.63 × 3.52 m²

Bathroom
1.85 × 2.46 m²

Reception
4.29 × 6.51 m²

Bedroom 01
3.72 × 3.91 m²

Guest Toilet
2.19 × 1.57 m²

Bedroom 02
3.91 × 3.91 m²

Lobby 01
2.54 × 1.28 m²

Master Bedroom
3.91 × 4.06 m²

Kitchen
4.02 × 2.40 m²

M. Bathroom
1.98 × 2.68 m²

Lobby 02
2.74 × 1.28 m²

Dressing
1.99 × 2.68 m²



Disclaimer:

1.All dimensions will be measured from axis to axis. 2.All materials,dimensions and drawings are approximate information is subject to change without notice. 3.Actual area may vary from the stated area. 4.Drawing areas not to scale. 5.The developer reserves the right to make revisions. 6.Actual unit areas, front windows, porches, terraces,loggia and exterior trim detail may vary by elevation styles.

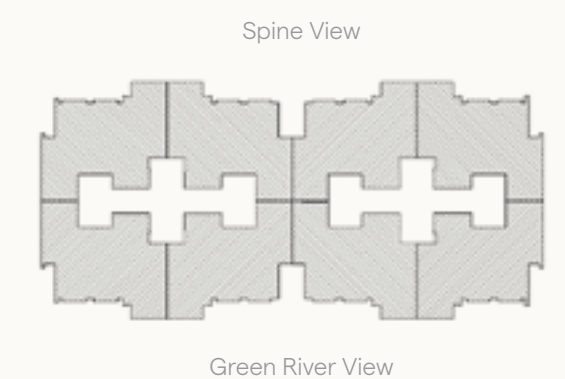

BUILDING K

RESIDENCE
EIGHT

Third and Fifth Floors

K - TYPICAL APARTMENT A-31/32

Available on Third Floor and Fifth.

Total Area
160 m²

Terrace 01
6.77 × 0.73 m²

Terrace 02
4.35 × 1.50 m²

Entrance
1.63 × 3.52 m²

Bathroom
1.85 × 2.46 m²

Reception
4.29 × 6.51 m²

Bedroom 01
3.72 × 3.91 m²

Guest Toilet
2.19 × 1.57 m²

Bedroom 02
3.91 × 3.91 m²

Lobby 01
2.54 × 1.28 m²

Master Bedroom
3.91 × 4.06 m²

Kitchen
4.02 × 2.40 m²

M. Bathroom
1.98 × 2.68 m²

Lobby 02
2.74 × 1.28 m²

Dressing
1.99 × 2.68 m²



Disclaimer:

1.All dimensions will be measured from axis to axis. 2.All materials,dimensions and drawings are approximate information is subject to change without notice. 3.Actual area may vary from the stated area. 4.Drawing areas not to scale. 5.The developer reserves the right to make revisions. 6.Actual unit areas, front windows, porches, terraces,loggia and exterior trim detail may vary by elevation styles.

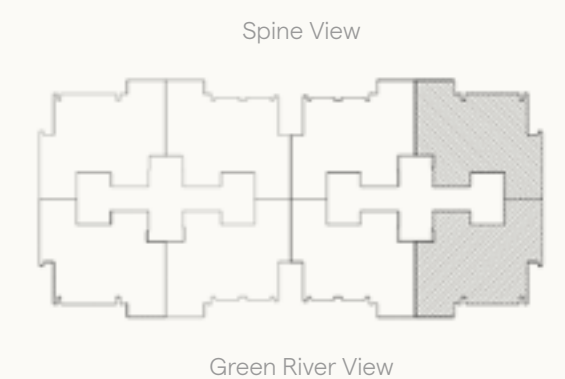

K - TYPICAL APARTMENT

A-33/34 B-31/32/33/34

Available on
Third Floor.

Total Area
155 m²

Terrace 01
2.44 × 0.30 m²

Terrace 02
4.35 × 1.50 m²

Terrace 02
2.44 × 0.30 m²

Entrance
1.86 × 3.52 m²

Bathroom
1.85 × 2.46 m²

Reception
4.29 × 6.56 m²

Bedroom 01
3.72 × 3.91 m²

Guest Toilet
2.19 × 1.57 m²

Bedroom 02
3.91 × 3.91 m²

Lobby 01
2.54 × 1.28 m²

Master Bedroom
3.78 × 4.06 m²

Kitchen
4.02 × 2.40 m²

M. Bathroom
1.98 × 2.68 m²

Lobby 02
2.74 × 1.28 m²

Dressing
1.86 × 2.68 m²



Disclaimer:

1.All dimensions will be measured from axis to axis. 2.All materials, dimensions and drawings are approximate information is subject to change without notice. 3.Actual area may vary from the stated area. 4.Drawing areas not to scale. 5.The developer reserves the right to make revisions. 6.Actual unit areas, front windows, porches, terraces, loggia and exterior trim detail may vary by elevation styles.

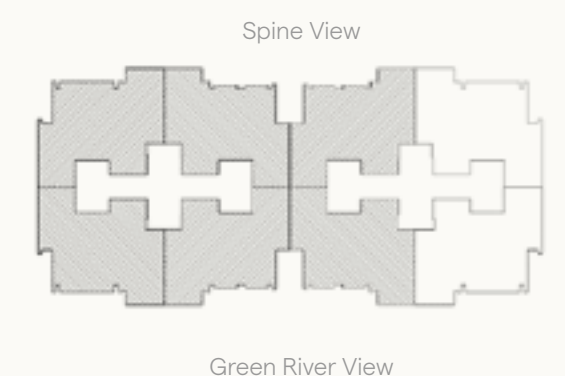

BUILDING K

RESIDENCE
EIGHT

SEVENTH FLOOR

K - TYPICAL APARTMENT

A-71/73 B-71/73

Available on
Seventh Floor.

Total Area
155 m²

Terrace 01
2.44 × 0.30 m²

Terrace 03
3.95 × 1.23 m²

Terrace 02
2.44 × 0.30 m²

Entrance
1.63 × 3.52 m²

Bathroom
1.85 × 2.46 m²

Reception
4.29 × 6.51 m²

Bedroom 01
3.72 × 3.91 m²

Guest Toilet
2.19 × 1.57 m²

Bedroom 02
3.91 × 3.91 m²

Lobby 01
2.54 × 1.28 m²

Master Bedroom
3.91 × 4.06 m²

Kitchen
4.02 × 2.40 m²

M. Bathroom
1.98 × 2.68 m²

Lobby 02
2.74 × 1.28 m²

Dressing
1.99 × 2.68 m²



Disclaimer:

1.All dimensions will be measured from axis to axis. 2.All materials,dimensions and drawings are approximate information is subject to change without notice. 3.Actual area may vary from the stated area. 4.Drawing areas not to scale. 5.The developer reserves the right to make revisions. 6.Actual unit areas, front windows, porches, terraces,loggia and exterior trim detail may vary by elevation styles.

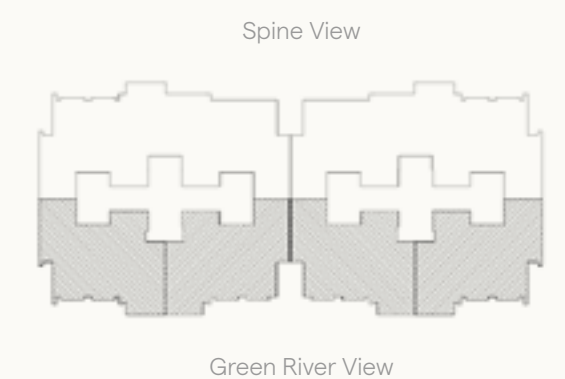

K - HORIZON APARTMENT

A-72 B-72

Available on Seventh Floor.	Total Area 245 m²	Terrace 01 2.44 × 0.30 m²	Terrace 02 2.44 × 0.30 m²
	Terrace 03 4.07 × 1.23 m²	Terrace 04 4.55 × 1.50 m²	Outdoor Terrace 10.45 × 7.37 m²

Entrance
1.81 × 3.22 m²

Laundry
1.88 × 2.46 m²

Reception
5.06 × 4.69 m²

Bathroom
1.85 × 2.46 m²

Dinning
4.27 × 3.56 m²

Bedroom 01
3.72 × 3.91 m²

Guest Toilet
2.19 × 1.57 m²

Bedroom 02
3.91 × 3.91 m²

Living
4.29 × 6.56 m²

Master Bedroom
3.91 × 4.06 m²

Kitchen
4.00 × 3.97 m²

M. Bathroom
1.98 × 2.68 m²

Lobby 01
5.28 × 1.28 m²

Dressing
1.99 × 2.68 m²

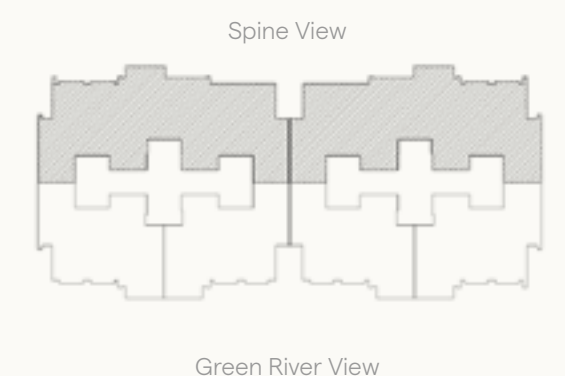

Disclaimer:
 1.All dimensions will be measured from axis to axis. 2.All materials,dimensions and drawings are approximate information is subject to change without notice. 3.Actual area may vary from the stated area. 4.Drawing areas not to scale. 5.The developer reserves the right to make revisions. 6.Actual unit areas, front windows, porches, terraces,loggia and exterior trim detail may vary by elevation styles.

**SKY AD.
DEVELOPMENTS**